

# ANNUAL REPORT 2022

**OPEN HOUSE MELBOURNE  
ANNUAL REPORT 2022**

**WE ACKNOWLEDGE THAT WE STAND ON THE LAND OF THE PEOPLE OF THE KULIN NATION—PHYSICALLY AND VIRTUALLY. OUR PROGRAMMING EXISTS ON WHAT ALWAYS WAS AND ALWAYS WILL BE ABORIGINAL LAND AND WE PAY OUR RESPECTS TO ELDERS PAST, PRESENT AND EMERGING.**

**AS NON-ABORIGINAL PERSONS, WE RECOGNISE THAT WE BENEFIT FROM LIVING AND WORKING ON ABORIGINAL LAND AND ACKNOWLEDGE THAT INDIGENOUS SOVEREIGNTY HAD NEVER CEDED. THIS FACT REMAINS AT THE FOREFRONT OF OUR MIND EVERY DAY GIVEN OUR FOCUS ON THE MODERN BUILT ENVIRONMENT.**

Message from the President	9
Message from the Executive Director and Chief Curator	10
Our People	14
Management Committee Governance	16
Partners + Finance	20
Open House Program Review	24
Volunteer Engagement	48
Reach + Profile	50
Learnings + Reflections	57
Appendix	60

## CLIMATE STATEMENT

---

**OPEN HOUSE MELBOURNE  
ACKNOWLEDGES THE SCIENTIFIC  
CONSENSUS REGARDING THE  
REALITY OF HUMAN-INDUCED  
CLIMATE CHANGE AND THE  
SUBSTANTIAL CONTRIBUTION  
CONSTRUCTION, AND OUR BUILT  
ENVIRONMENT MAKE TO GLOBAL  
GREENHOUSE GAS EMISSIONS.**

**OPEN HOUSE MELBOURNE IS  
COMMITTED TO SUPPORTING  
ENDEAVOURS TO REDUCE  
EMISSIONS AND SHOWCASING  
THE CRITICAL ROLE OF GOOD  
DESIGN IN MAKING OUR  
CITIES SUSTAINABLE.**

# OUR VISION, OUR MISSION, + OUR THEMATIC PILLARS

Open House Melbourne’s vision is to inspire and empower all Victorians to respect and care for place and to champion the power of good design in shaping the future of our built environment.

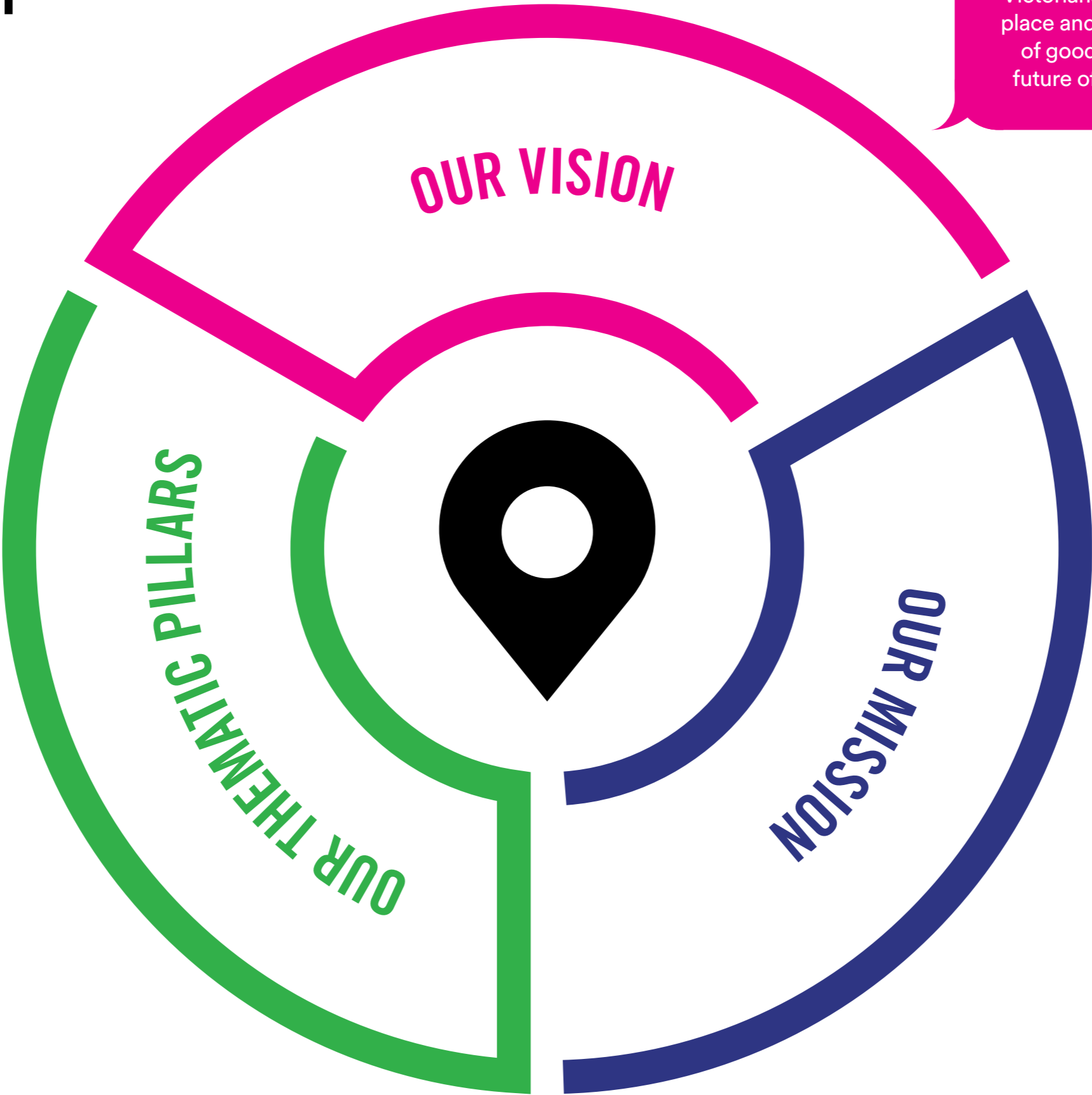

- **First Peoples First:**  
Indigenous knowledges and designing on Country
- **Design of Public Life:**  
The future of work, home and leisure
- **Climate Crisis:**  
Sustainable practices and the carbon-neutral city
- **Home Truths:**  
New models for adaptive and responsive housing
- **More than Human Urbanism:**  
Design, ecology and the natural world
- **Accessibility and Inclusion:**  
Designing spaces for care and possibility for all

Through collaborative, creative and impactful programs, Open House Melbourne leads critical public debate on the value of place and design, empowering all Victorians to understand the important role they can play in shaping our built and natural environments.

Essential to our mission is recognising First Peoples’ knowledges and sovereignty, campaigning for sustainability toward a net-zero future and advocating for good design that is inclusive and accessible to all.





# MESSAGE FROM THE PRESIDENT

**WE STARTED 2022 FULL OF OPTIMISM ABOUT A RETURN TO THE CITY—AND THE YEAR HAS BEEN A SUCCESSFUL RETURN TO THE PLACES THAT MEAN THE MOST TO US. BUT IT TURNS OUT, IT'S NOT JUST ABOUT THE CITY ANYMORE.**

It's been a year of renewal and outreach at Open House Melbourne. OHM has completed a strategic review of the organisation and updated our vision, which put Indigenous knowledges and designing on Country first. OHM's reach is now Victoria wide, as reflected in our regional partnerships—this year through Open Nature and Open House Bendigo—and a wider shift coming out of the COVID-19 pandemic to regional cities, towns and landscapes. This wider focus is also shared by large sporting and cultural programs such as the 2026 Commonwealth Games, which is based around the regional centres that arc through our state.

Open House Melbourne's programming, led by Fleur Watson, Executive Director and Chief Curator, has been exceptional. After two years of mostly virtual events, OHM has launched and undertaken Open Nature, in partnership with Melbourne Design Week; had a bumper Open House Weekend in July 2022; and more recently, a successful return to Bendigo for a terrific program of what Open House does well—open buildings, places and discussions.

Open House Melbourne July Weekend 2022, based around the theme of Built/Unbuilt, had over 200 program items—and the sun shone on us. As a punter it was rich pickings during the sunny winter days. A distributed exhibition of installations throughout a range of buildings and spaces—*Take Hold of the Clouds*—was an excellent innovation of OHM programming. Four evening events, from Thursday to Sunday, were presented: a new edition of *Modern Melbourne*, the return of *This is Public, Design: Building on Country* and the annual Heritage Address, this year with Katrina Sedgwick and appropriately held at Federation Square. Fed Square turned 20 this year, and at a recent celebration at the Square, it struck me how much Melbourne had changed in that time—and how OHM had become part of Melbourne; committed, like the Square, to fostering good design and discussion about place.

2022 also saw Open House Melbourne move home—from the historic richness of Tasma Terrace near Spring Street to Collingwood Yards with other like-minded organisations in an excellent example of adaptive re-use. We hope to make the most of this excellent facility in coming years.

OHM has always done a lot with modest means—we are a not-for-profit with a small number of paid staff and a volunteer board. The staff have been exceptional, working as a team under Fleur Watson, and I would like to personally thank Helen Sweatman, Isabella Radevski and Piera Maclean for their efforts. Our volunteers continue to do amazing work and I thank them also.

Open House Melbourne relies on the support of many fantastic partners, with whom we share values of supporting good design—and I thank them for their ongoing support and look forward to working together in the future. We also encourage new partners to join us—OHM is always keen to establish supportive and collaborative partnerships. I particularly want to thank those

supporters who stuck with us through the pandemic. On a personal note, I wish to thank former OHM president Shaun Newing for his guidance over the past 12 months since I became president of the OHM board. Shaun has Open House Melbourne running through his veins and we are glad he remains part of the OHM community. I would also like to thank fellow board members. We welcomed Amy Muir and Naomi Stead, and welcomed back Mark Davis to the board; and thanked departing board members Shelley Penn, Quan Payne and Von Slater for their service, and Jeremy King, soon to depart, who has provided countless legal advice and wisdom over the years.

The final note for the year is on illustrious Fleur Watson, who has successfully guided the organisation through a complex and difficult period since joining in the lead role in September 2020. Her skill in producing Open House Melbourne's year-round program, ability to navigate complex funding models, managing an office, and creating on-line and live events in a time of crisis has been exceptional. It is with sadness that we announce Fleur is moving on from the ED/CC role at the end of year to take up a position at RMIT, one of OHM's partners. Fleur will continue to be part of OHM as a board member. The process to find the next ED/CC has begun and we thank Fleur for striving to make Open House Melbourne both part of Melbourne's cultural map but also across the state of Victoria.



**STUART HARRISON**  
Director, Harrison & White  
Board Member and President, Open House Melbourne

# MESSAGE FROM THE EXECUTIVE DIRECTOR AND CHIEF CURATOR

## BETWEEN THE BUILT AND THE UNBUILT

In 2022—after two years of hybrid programming—Open House Melbourne made a long-awaited and successful return to ‘in-person’ programming and events. We delivered our most extensive and diverse public program to date and continued to expand OHM’s mission to inspire and empower all Victorians to respect and care for place and champion the power of good design in shaping the future of our built environment.

Opening the year, we presented Open Nature—a newly created series of guided walks, talks, tours and workshops across the city of Melbourne and central Gippsland as part of Melbourne Design Week. Open Nature explored a growing movement toward ecologically responsive, ‘more than human’ design practices that recognise the complex interrelations between humans and non humans. Critical to this movement is the understanding that the health and sustainability of our natural ecosystems are vital to a thriving future for us all.

Program highlights included working with the Birrarung Council and the Wurundjeri Woi Wurrung Cultural Heritage Aboriginal Corporation to explore bi-cultural design approaches for the Great Birrarung Parkland—a vision for the river as one great living entity. An interactive workshop aboard the Yarra Countess with designer and researcher Alex Goad to learn more about ‘soft’ infrastructure design approaches to coastal defence and, a guided bike tour led by Archi Tours to explore Port Phillip Bay from Williamstown port to the mangrove colony and shacks of the Kororoit Creek estuary.

In July, we launched the 16th edition of the OHM Weekend festival—our flagship program—with the overarching theme of Built/Unbuilt. The festival brought together over 200+ events including tours, lectures, keynotes and talks, workshops, performances and exhibitions.

Built/Unbuilt celebrated the contribution and impact of good design in our built environment yet also explored the city and suburbs at diverse scales and systems—the urban, civic, public, landscape and interior; as well as those spaces that are ‘unbuilt’ and in-between the designed elements of the public realm. The theme unpacked ideas of how the built environment contributes to and shapes public life; the relationship between the built and natural world; and propositions of how we might recognise and acknowledge the pre-histories and afterlives of places, spaces and buildings.

This is Public—OHM’s annual speaker series—marked the Weekend’s ‘official’ opening. Contributors presented their practice and research in response to the theme of Built/Unbuilt. The result was a rich and diverse range of presentations that explored ways in which cultural memory and knowledge could be revealed and registered in our built environment—now and into the future.

We also delivered a new collaborative project titled *Take Hold of the Clouds*—a distributed exhibition produced and curated with Tara McDowell, Director of Curatorial Practice at Monash University’s Faculty of Art, Design and Architecture. The exhibition brought together eight creative practitioners—two international and six local—drawn from visual arts, architecture, design, sound and film to make installations in response to a diverse range of sites. Embedding the work within the city itself rather than a traditional gallery, the project modelled sustainable and resource-sensitive exhibition-making and revealed the invisible stories and pre-histories of the buildings, landscapes and interior spaces.

The July program culminated at Federation Square with the annual 2022 Heritage Address delivered by Katrina Sedgwick OAM. Speaking in the context of her newly appointed role as the CEO of Melbourne Arts Precinct Corporation (MAP Co), Sedgwick’s inspiring lecture reflected on historical and contemporary precedents for cultural centres in Australia and overseas, and her emerging vision for Map Co’s remit. She proposed how we might collectively consider ‘future heritage’ for Melbourne’s cultural precinct as we embark upon a time of significant development and investment.

Over the July period, the Built/Unbuilt program amassed over 619,220 visits and views comprising physical tours, talks, live events, exhibition and studio visits, website unique page views, virtual tour views, and video content views. This figure clearly demonstrates the impact and popularity of a long-awaited return to physical programming and the contribution that the festival makes to the city and our suburbs. The program was augmented with live-streamed events, online and virtual tours, and recorded ‘on-demand’ offerings to ensure accessibility to the festival beyond Melbourne’s city and suburbs as we continue to emerge and learn from the experiences of the COVID-19 pandemic.

In October, we returned to the regions to deliver the Open House Bendigo Weekend—our first since 2019. The program aspired to

create a sense of civic pride in the changing urban environment of Greater Bendigo and further expanded OHM’s commitment to Victoria-wide programming and regional–city exchange. Critical to the program’s success was working integrally with local partners to curate the content including the Dja Dja Wurrung Clans Aboriginal Corporation, the Greater City of Bendigo and the La Trobe Institute of Arts—the latter of which hosted a ‘mini-marathon’ talk series Culture of Place: Bendigo and the Big Build, exploring the contribution and impact of three new, large-scale civic and educational buildings that are shaping the centre of the city.

Additional opening highlights included a Walk on Country and Smoking led by Dja Dja Wurrung Traditional Owners exploring a re-imagined future for Bendigo Creek; a landscape tour of Bendigo’s ‘Garden for the Future’ led by TCL landscape architects; and ‘The Big Draw’—an interactive workshop at Bendigo Gallery for children and families. On Sunday architect and housing advocate Tania Davidge hosted an insightful and vital discussion at Bendigo’s Engine Room that focused on issues that influence the provision of social and affordable housing in the region. The program brought together Rachel Gellatly from Haven Home Safe, architect Clare Cousins from Clare Cousins Architects (CCA) and Toby Dean from Nightingale Housing in a panel discussion to unpack what public and community housing looks like in regional Victoria and the key concerns that drive its delivery.

To close the year, Open House launches a brand-new series of summer walking tours aptly named Stroll the City in partnership with the City of Melbourne and guided by experts across urban design, architecture, landscape and ecology disciplines. The series will kick off in December and extend through the summer months and form a pilot for a future annual program of monthly walking tours. The tours will also be recorded to offer virtual ‘strolling’ wherever you may be in Victoria or afar.

Open House Melbourne is supported by the generosity of many dedicated organisations and people—the OHM Management Committee (Board), Building Council, Volunteer Council, Association Members, our much-valued Practice and Precinct Partners, Media Partners, Donors and Supporters and over 400 passionate and pink-vested volunteers. We extend our deep appreciation for your vital support. A special mention to OHM’s long-term partners Efront and Studio Payne for pushing the boundaries with OHM’s branding and website design this year.

My sincere thanks to the small but mighty OHM team—Helen Sweatman, Isabella Radevski, Piera Maclean—for their unwavering commitment to creating impactful and engaging public programming. These three women are the ‘engine room’ of the organisation and are to be commended for their efforts and professionalism. Thank you to Brianna Carroll for her valued contribution over a three-year period and to our volunteer coordinator Lucy Heath.

At the conclusion of 2022, I will hand over the leadership reins at Open House Melbourne to pursue a new professional chapter. The opportunity to lead this extraordinary not-for-profit organisation has been immensely rewarding and a great privilege. I’m proud of what we have collectively created and achieved in the most challenging times. I’m also delighted to join the Open House Melbourne Board and continue to support the organisation and our strategic objectives from 2023 and beyond.



**FLEUR WATSON**  
Executive Director | Chief Curator, Open House Melbourne



HERALD SUN

GRAY WEST

QUALITY

southgate

PRINCES BRIDGE 1884



# OUR PEOPLE

## OPEN HOUSE TEAM

---

### FLEUR WATSON

Executive Director / Chief Curator  
1EFT January–December 2022

### HELEN SWEATMAN

Business and Operations Manager  
1EFT 2022, continuing in 2023

### BRIANNA CARROLL

Program and Communications Manager  
1EFT January–March 2022

### ISABELLA RADEVSKI

Program and Communications Manager  
1EFT January 2022, continuing in 2023

### PIERA MACLEAN

Project and Events Coordinator  
1 EFT May 2022, continuing in 2023

The core team was supported by contractor Lucy Heath—as acting Volunteer Coordinator for the Open House Melbourne Weekend.

## BUILDING COUNCIL

---

### STEVE STEFANOPOULOS (CHAIR)

### ANNA O’SULLIVAN

### BEC HENRY

### KAT SMITH

### MELANY HAYES

### TANIA DAVIDGE

## VOLUNTEER COUNCIL

---

### NEIL HARKNESS (CHAIR)

### ANDREW PURVIS

### ELENI KAPONIS

### ELOISE GLANVILLE

### JOY VILLALINO

### STEPHANIE BATEMAN

### VICTORIA BENNETT

A special thank you to Anna O’Sullivan, Steve Stefanopoulos and Neil Harkness for leading as Council Chairs during 2022.

## MANAGEMENT COMMITTEE

---

### STUART HARRISON

Director, Harrison & White  
Board Member and President

### EMMA TELFER

Chief Operating Officer, Assemble  
Board Member and Vice President

### AMY MUIR

Director, MUIR Architecture  
Board Member and Secretary

### MATTHEW BOWEN

CA, Director, Syracuse  
Board Member and Treasurer

### JEREMY KING

Partner, Pinsent Masons  
Board Member

### NAOMI STEAD

Director, RMIT University  
Board Member

### MARK DAVIS

Technology Director, Today  
Board Member

## OUR AMBASSADOR

---

### PETER MADDISON

## OUR PATRONS

---

### DANIEL DORALL

### JOY VILLALINO

### ALAN SHAW

## ASSOCIATION MEMBERS

---

### ADAM PUSTOLA

### ALISON CLEARY

### BEN MORGAN

### CHARLES TREMLETT

### DAMIAN BUTLER

### DAMIAN SABATINI

### DANIELLE JOHNSTON

### EMMA APPLETON

### HUGH FALCON

### JACQUELINE DI BLASI

### JIM GARDINER

### JOHN PETIT

### KIERAN LEONG

### KIM IRONS

### LEO MARTIN

### LYNNE PEPPER

### MARCIA HARKINS

### MARGOT WILLUMSEN

### MARY DOUGHERTY

### NATHAN MILESI

### NIC CULNANE

### NICK ROUSE

### PATRICK RUNDLE

### PAUL BORELLA

### PHOEBE HARRISON

### QUAN PAYNE

### ROHAN TROLLOPE

### SALLY DOBELL

### SHELLY PENN

### SHAUN NEWING

### SIMON JOHSON

### SOPHIE NEWING

### STEVEN NEAVE

### TIM LESLIE

### VON SLATER

## OUR VOLUNTEERS

---

Our organisation relies on the incredible goodwill of the people of Victoria. People give to Open House Melbourne in so many ways—from volunteering with OHM to opening their building or home; providing spaces for an event; donating their time and expertise; providing their endorsement of our events; or a myriad of other ways.

We are so very grateful for your support of Open House Melbourne and we hope to continue working with you over the many years to come. Thank you.

Additionally, all current members of the Building Council and Volunteer Council serve as Association Members.

# MANAGEMENT COMMITTEE GOVERNANCE

## INTRODUCTION

Following two years of isolation due to the COVID-19 pandemic, the Management Committee was keen to try and again meet face to face in 2022. Monthly meetings were held as a hybrid model to allow for flexibility while acknowledging the benefits of meeting in person. The focus of the meetings has been to discuss and review the overall strategy and growth of Open House Melbourne, with a particular focus on financial stability and varied models of fundraising and philanthropy. Support has also been provided in the broadening of the program across the year to deliver varied engagement and advocacy while establishing more sustainable working models for the organisation.

## OUR PEOPLE

The beginning of the year saw several changes to the OHM Board under the leadership of Fleur Watson as Executive Director and Chief Curator. Stuart Harrison stepped up as President, replacing Shaun Newing who had held the position since January 2020. Shaun was a co-founder of Open House Melbourne in 2008 and has been an Association Member ever since. We thank Shaun for his extraordinary contribution and leadership of the organisation. Former OHM Executive Director and Board Member Emma Telfer took on the role of Vice President. Naomi Stead and Amy Muir (Secretary) joined as new members with previous member Mark Davis re-joining the board. Additional continuing board members are Jeremy King and Matthew Bowen (Treasurer).

We would also like to acknowledge the highly valued work of outgoing Vice President, Shelley Penn, along with former Secretary, Von Slater, and Quan Payne. Studio Payne continues to support OHM's branding and identity.

It has been wonderful to see the team grow over the past year as we welcomed Isabella Radevski, Program and Communications Manager, and Piera Maclean, Program and Events Coordinator. They have been working tirelessly with Helen Sweatman, Business and Operations Manager, and Fleur Watson to deliver seamless and engaging programs and events throughout the year. We farewellled Brianna Carroll and thank her for her commitment and passion to the organisation through her role as Program and Communications Manager.

Thank you also to our Building Council, Volunteer Council and volunteers who remain passionate and dedicated to the Open House movement and its work in Melbourne. Without their support OHM would not be able to achieve its ambitious vision.

## STRATEGIC PLANNING WORKSHOP

Following on from the initial workshop in November 2021, the Open House Melbourne Management Committee in February 2022 held a strategic planning workshop facilitated by Greenshoot Consulting. The workshop resulted in the Committee finalising the organisation's three-year strategy, which has now been adopted into a strategic plan that is available for your information on the Open House Melbourne website.

## SUB-COMMITTEE / ADVISORY GROUPS

Three subcommittees and one advisory group were established in 2021 to provide specific areas of focus and advice to the management team. These subcommittees continued to develop through 2022 with the recent addition of the 'Commonwealth Games' subcommittee. Each subcommittee meets regularly to address the outcomes for each group.

See below the summary of responsibilities for each committee:

### © FUND RAISING AND PHILANTHROPY

Chair: Emma Telfer

This subcommittee's purpose is to support the ED/CC to:

- identify and track new partnership opportunities including through the wider OHM and committee networks;
- develop a strategy to attract philanthropic funding through high net worth channels;
- build non-government related funding.

### © RISK & FINANCE

Chair: Amy Muir

This subcommittee's purpose is to:

- develop and implement a risk register and policy;
- monitor the risk register;
- monitor cash flow and financial stability.

The subcommittee will guide and support operational staff to ensure processes are compliant and achievable within a small team, not-for-profit environment. The focus of the committee has been the establishment of a Risk Register for 2022–2023. This is currently being refined through the review of external parties.

### © PROGRAM ADVISORY GROUP

Co-chairs: Naomi Stead / Fleur Watson

The subcommittee's purpose is to:

- identify programming opportunities;
- offer feedback and advice on programming submissions and partnerships;
- be a 'connector and advocate' to secure funding support in relation to operational and programming growth for Open House Melbourne.

### © VICTORIA 2026 COMMONWEALTH GAMES

Chair: Stuart Harrison

The subcommittee's purpose is to:

- identify opportunities associated with the Victoria 2026 Commonwealth Games;
- liaise with members of Victoria 2026 to strategise suitable opportunities.

# MANAGEMENT COMMITTEE MEETING ATTENDANCE

MEETING NUMBER	MEETING DATE	STUART HARRISON PRESIDENT	EMMA TEFLER VICE PRESIDENT	AMY MUIR SECRETARY	MATTHEW BOWEN TREASURER	JEREMY KING MEMBER	NAOMI STEAD MEMBER	MARK DAVIS MEMBER
01-2022	01.02.2022	Y	Y	Y	Y	Y	Y	Y
02-2022	08.02.2022	Y	Y	Y	Y	N	Y	Y
03-2022	01.03.2022	Y	Y	Y	Y	Y	Y	Y
04-2022	12.04.2022	Y	N	Y	Y	N	N	Y
05-2022	17.05.2022	Y	Y	Y	Y	N	Y	N
06-2022	14.06.2022	Y	Y	Y	Y	Y	Y	Y
07-2022	12.07.2022	Y	Y	Y	Y	Y	Y	Y
08-2022	16.08.2022	Y	Y	Y	Y	Y	Y	N
09-2022	19.09.2022	Y	Y	Y	Y	N	N	Y
10-2022	18.10.2022	Y	Y	Y	Y	Y	Y	N

# The Social Studio



# PARTNERS

## MAJOR SPONSORS & PROGRAM PARTNERS

CREATIVE VICTORIA  
CITY OF MELBOURNE  
CITY OF GREATER BENDIGO  
NATIONAL GALLERY VICTORIA  
EFRONT

## SPONSORS

HERITAGE COUNCIL OF VICTORIA  
DELWP  
OVGA

## MAJOR PRECINCT PARTNERS

CITY OF PORT PHILLIP  
CITY OF STONNINGTON  
SPRING PLACE  
UNIVERSITY OF MELBOURNE

## PRECINCT PARTNERS

CITY OF BOROONDARA  
CITY OF HOBSONS BAY  
CITY OF MARIBYRNONG

## MAJOR PRACTICE PARTNERS

COX  
LOVELL CHEN

## PRACTICE PARTNERS

ARCHITECTUS  
BATES SMART  
BEST  
FENDER KATSALIDIS  
GJM HERITAGE  
GRIMSHAW  
JOHN WARDLE ARCHITECTS  
MODSCAPE  
NH  
SIX DEGREES ARCHITECTS

## PROGRAM PARTNERS

ARCHITEAM  
DJA DJA WURRUNG CLANS  
ABORIGINAL CORPORATION  
FED SQUARE  
JANE'S WALK  
KOORIE HERITAGE TRUST  
MONASH UNIVERSITY  
NAOMI MILGROM FOUNDATION  
PETER ELIOTT ARCHITECTURE +  
URBAN DESIGN  
RMIT UNIVERSITY  
THE CAPITOL  
LATROBE CITY | GIPPSLAND  
PERFORMING ARTS CENTRE  
LA TROBE UNIVERSITY | LA TROBE  
ART INSTITUTE

## MEDIA & DIGITAL PARTNERS

ARCHITECTURE MEDIA  
ELLIKON  
PHORIA  
PLAKKIT  
STUDIO PAYNE  
UNKNOWN VISION  
ZILLA & BROOK

## SUPPORTERS

AUSTRALIAN INSTITUTE OF  
ARCHITECTS  
COLLINGWOOD YARDS  
LITTLE LON DISTILLING CO.  
COMMITTEE FOR MELBOURNE  
CORRS CHAMBERS WESTGARTH  
NATIONAL TRUST OF AUSTRALIA  
(VICTORIA)  
OPEN HOUSE WORLDWIDE  
PINSET MASONS  
SAFETY IN NUMBERS  
SYRACUSE

# FINANCE

**REVENUE IN 2022 IS RECORDED AS \$612,090 AN INCREASE OF \$126,391 COMPARED TO 2021 (\$485,699) AND PROFIT OF \$10,486.**

The government's economic support packages contributed a total of \$5,600 (compared to \$87,050 in 2021).

2022 saw further increases in government funding programs and corporate support remained steady.

Other funding streams remain relatively unchanged from previous years.

## • FUNDING MIX—2021 V 2022

### GOVERNMENT PROGRAM FUNDING

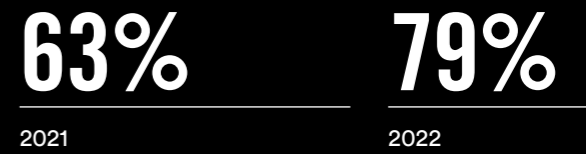

### CORPORATE SPONSORSHIP

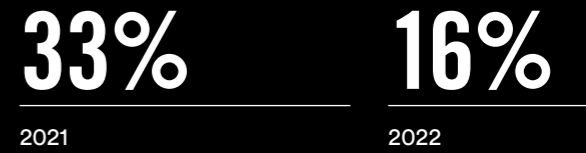

### EVENT REVENUE

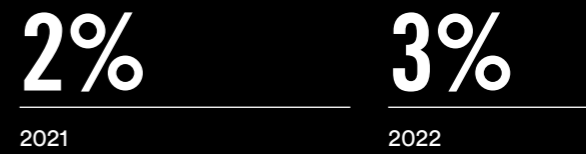

### MEMBERSHIP



### DONATIONS

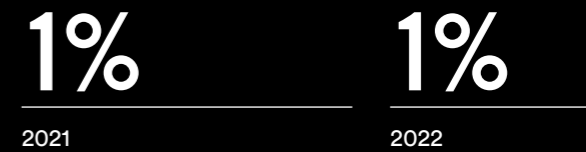



# OPEN HOUSE PROGRAM REVIEW



# OPEN NATURE— MELBOURNE DESIGN WEEK 18–27 MARCH

## 18

### PROGRAMS

## 535

### IN-PERSON ATTENDANCE

For Melbourne Design Week 2022, Open House Melbourne presented Open Nature—a newly created series of guided walks, talks, tours, workshops and events across the city of Melbourne and central Gippsland.

Open Nature expanded on the past three years of our much-loved *Waterfront* series, which focused on water-responsive design and the movement toward recognising water as a living entity to shape better outcomes for our creeks, rivers and oceans.

Curatorially, Open Nature broadened *Waterfront*'s focus by exploring a growing movement toward ecologically responsive, 'more than human' design practices that recognise the complex interrelations between humans and non-humans. Critical to this movement is the understanding that the health and sustainability of our natural ecosystems are vital to a thriving future for us all.

Furthermore, Open Nature recognises that as citizens—and as built environment professionals—we must urgently address the climate crisis, support sustainable practices toward a carbon-neutral future and practice deep listening and learning from First Peoples' knowledge of designing with Country. These fundamental principles drove our thinking and design of the Open Nature program.

In true 'Open House' fashion, Open Nature invited public audiences to immerse themselves in the city's streetscapes, waterways and landscapes through the lens of 'more than human' design. Events included guided walks, kayak and bike tours, workshops, meals, tastings and talks—all held within the 10-day envelope of the Melbourne Design Week festival. Co-produced with a diverse range of valued collaborators, each program was created in a spirit of welcoming exchange with the opportunity of learning through active participation.

Highlights of the program included: expanding our ongoing collaboration with the Birrarung Council and the Wurundjeri Woi Wurrung Cultural Heritage Aboriginal Corporation to explore bi-cultural design approaches for the Great Birrarung Parkland—a vision for the river as one great living entity. An interactive workshop and meal aboard the Yarra Countess with designer and researcher Alex Goad to learn more about 'soft' infrastructure design approaches to coastal defence with experimental culinary lab Long Prawn. And, on a gloriously sunny Saturday morning,

participants embarked on a guided bike tour led by ArchiTours to explore Port Phillip Bay's western edge from Williamstown port to the mangrove colony and shacks of the Kororoit Creek estuary.

Importantly, as part of Melbourne Design Week, Open Nature also provided an opportunity to program regionally—this year focusing on the Latrobe Valley and in partnership with the newly opened Gippsland Performing Arts Centre (GPAC) in Traralgon. Conceived as a one-day intensive program—free and open to all—Open Nature: Gippsland Design Day was organised in four parts to create meaningful exchange between the city and the region.

The day commenced with a Welcome to Country and Smoking Ceremony led by Heather Hood and Tre Moffatt from the Gunaikurnai Land and Waters Aboriginal Corporation in the outdoor courtyard of the cultural centre before participants were welcomed into the newly designed spaces of the theatre for informal presentations by invited speakers.

The first theme of the day explored projects which highlighted opportunities for 'creative entrepreneurship in the Latrobe Valley', with keynote presentations by Ross Harding of Finding Infinity exploring the potential for large-scale solar and wind agriculture projects for the region; followed by Paul Katsieris from Katsieris Origami discussing the innovative design behind the new GPAC building and the architects' collaboration with local producer Ash Timber in using large-scale, sustainable, engineered timber.

The second session focused on the growing reputation of 'Gippsland as a clean, green and trusted food producer' with presentations by John Calabro—founder of the influential broadsheet Gippslandia; followed by a wonderfully generous conversation between Gabrielle and Chris Moore of Sailors Grave brewery and Indigenous author Bruce Pascoe. Together, Gabrielle, Chris and Bruce—in conversation with GPAC's Bec Cole—shared stories about their intentions and collaboration for Sailors Grave's Dark Emu lager, which brings together seasonal ingredients and foraged indigenous botanicals to explore sustainable and ecologically sustainable methods of production.

Following the presentations, Design Day concluded with a special 'behind the scenes' tour led by Paul Katsieris with Sarah Jackson of Jackson Architecture—the architects-in-association for the new GPAC building. The event culminated in an opportunity for 'sustainable tastings' with growers from the region including Flooding Creek Fungi, Wattlebank Farm and Sailors Grave.

Open Nature was made possible thanks to the curatorial team at the NGV and to Creative Victoria, and a special thank you to Bec Cole and her team at the Gippsland Performing Arts Centre (GPAC) for their partnership for Gippsland Design Day. We also particularly acknowledge the support of GLaWAC, Birrarung Council, Wurundjeri Woi Wurrung Cultural Heritage Aboriginal Corporation and all Indigenous and Torres Strait Peoples across the state for generously sharing their knowledge of Country.

*Open Nature was presented by Open House Melbourne as part of Melbourne Design Week—an initiative of the Victorian Government in collaboration with the NGV.*



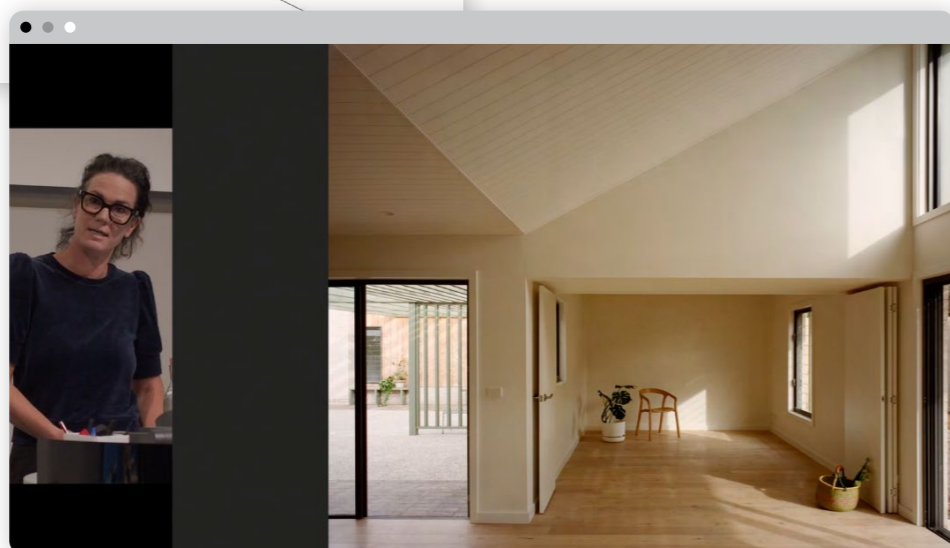
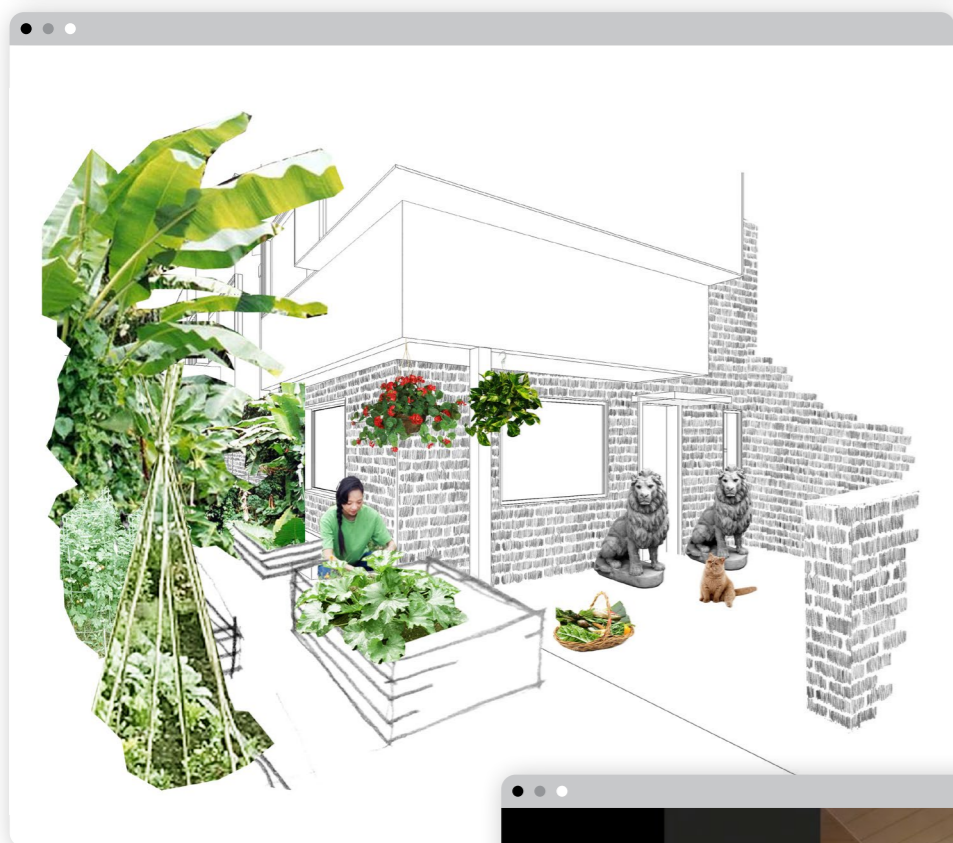
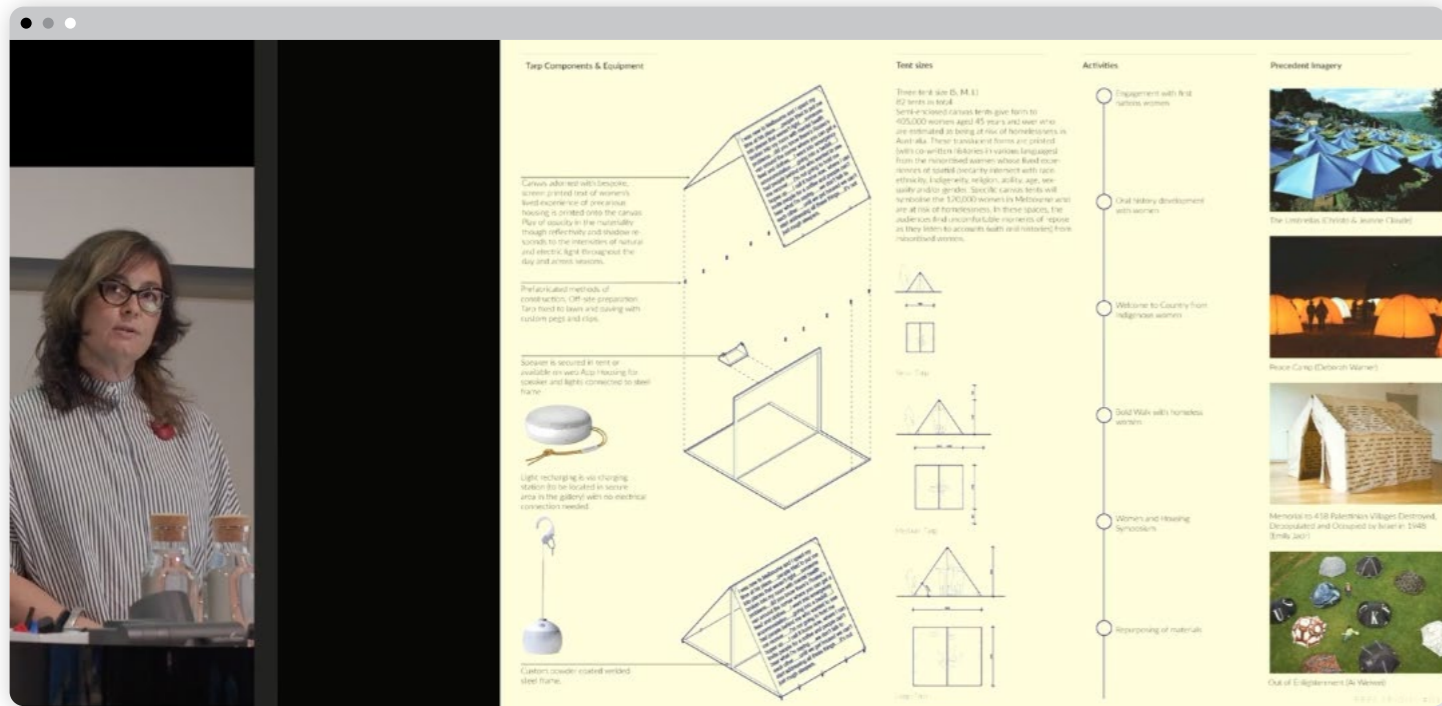

# KEEPING HOUSE: SECURE HOMES FOR WOMEN— PART OF OPEN HOUSE WORLDWIDE 7+9 APRIL

**80**  
IN-PERSON ATTENDANCE

**7K**  
ONLINE (COMBINED OHWW +  
OHM CHANNELS)

As part of the Open House Worldwide Festival (OHWW) and in partnership with not-for-profit community housing provider Women's Property Initiatives (WPI), OHM invited audiences to consider the big questions about the future of housing with an illustrated talk and panel discussion *Keeping House: Secure Homes for Women*.

Launched to the public on International Women's Day, the event explored the complex web of economic, political and cultural forces in Victoria as they impact access to affordable, safe and secure housing for women and women-led households.

Mel Bright, director of Studio Bright, presented the practice's recently completed Older Women's Housing Project, a pilot project led by WPI and designed to accommodate older single women who are on lower incomes and at risk of homelessness, with the intent to provide these women with security of tenure and enduring affordability.

Sophie Dyring, director of Schored Projects presented her practice's approach to design and advocacy in the social housing space, expanding on Schored's work with WPI through the social housing projects Coburg Townhouses and Pakenham Family Housing.

These real-world examples led into a deeper conversation around diverse housing models at a time when access to well-designed and affordable housing continues to be a critical issue. The panel discussion and audience Q&A included WPI's CEO Jeanette Large and development manager Natasha Liddell; guest speakers Mel Bright and Sophie Dyring; and was moderated by Tania Davidge, OHM Building Council member, architect, writer, researcher and co-founder of the architectural research practice OoPLA. Julie Willis, Professor of Architecture and Dean of the Faculty of Architecture, Building & Planning at the University of Melbourne introduced the event, which was held at and supported by the Melbourne School of Design at the University of Melbourne.

We recorded and edited the live event as part of OHWW, which was then broadcast live as part of their annual digital festival. The recording continues to be watched on both OHWW and OHM channels.



# OHM JULY WEEKEND 30+31 JULY

# 69,345

IN-PERSON ATTENDANCE

# 5,850

ONLINE

In 2022, after two years of virtual programming due to the COVID-19 pandemic, Open House Melbourne's July Weekend made a successful and long-awaited return to physical form to 'open up' a diverse range of heritage and contemporary spaces across the city for the public to experience and encounter.

The overarching theme for this year—Built/Unbuilt—aimed to catalyse a city-wide conversation about the future of architecture, landscape and urban design through the lens of the pressing issues facing Australian cities today. Built/Unbuilt explored how the built environment contributes to and shapes public life; examined the relationship between the built and natural world; and proposed ideas of how to recognise and acknowledge the pre-histories and afterlives of places, spaces and buildings.

Built/Unbuilt celebrated the contribution and impact of good design in our built environment yet also explored the city and suburbs at diverse scales and systems—the urban, civic, public, landscape and interior; as well as those spaces that are 'unbuilt' and in-between the designed elements of the public realm.

In response, the program reflected upon the atmospheric impact of the built and profiled projects that pursue sustainable practices and net-zero outcomes. We also considered the experience and ongoing impact of the pandemic and how the experience of extended isolation shapes expectations of how we live and work and how we now gather in public, community and private spaces.

The 2022 Weekend program marked one of our most extensive and diverse programs to date, with over 200+ guided and self-guided tours, lectures, keynotes and talks, workshops, performances and exhibitions illustrating the public's appetite for a diversity of programs. These in-person offerings were supported by livestreamed events, online and virtual tours, and recorded 'on demand' programming to ensure accessibility to the festival beyond Melbourne's city and suburbs.

In summary, over the campaign period, Built/Unbuilt: OHM July Weekend 2022 amassed over 619,220 in-person visits and online views comprising of physical tours, talks, live events, exhibition and studio visits, website unique page views, virtual tour views, and video content views. This figure clearly demonstrates the impact and popularity of a long-awaited return to physical programming for Open House Melbourne's July Weekend and the contribution that the festival makes to the city and our suburbs. This physical engagement is further supplemented by livestreamed events and digital programming that supports OHM's commitment to accessibility and flexibility for audiences as we continue to emerge and learn from the experiences of the pandemic.



## • JULY WEEKEND HIGHLIGHTS

### TAKE HOLD OF THE CLOUDS IN-PERSON ATTENDANCE—5,067

As part of the July Weekend this year, OHM presented a special project *Take Hold of the Clouds*. Created in partnership with Monash University, the exhibition navigated the Weekend's theme of Built/Unbuilt through a series of thoughtful encounters in which artists reveal the invisible stories and issues in corners of the city.

*Take Hold of the Clouds* brought together cross-disciplinary creative practitioners from the visual arts, architecture, design, sound and film; each to respond to a selected site, ranging from buildings to urban landscapes to community spaces. The exhibition featured two key existing works by international contributors—Forensic Architecture's *Cloud Studies* (2021) and Cauleen Smith's *Sojourner* (2018)—along with six, newly commissioned, responsive works from local and national creative practitioners.

Distributed across seven of the city's most loved and significant buildings and urban spaces, each temporal creative work added a new layer to how we understand these spaces in relation to the world around us. Embedding the work within the city itself rather than a traditional gallery, the exhibition modelled best practice for high-impact yet sustainable and resource-sensitive exhibition-making.

A special limited-edition publication was created to facilitate a deeper exploration of these sites and works through responsive texts and typographic treatments, audio transcripts, image descriptions and downloadable PDFs, accessible via QR codes placed throughout publication. It comes wrapped in a dust cover which turns into a poster of in-situ exhibition images taken by Tom Ross. This publication, along with a [dedicated microsite](#), was developed in collaboration with Faye d'Evie, Luke Rigby and Yue Yang. As part of the exhibition's unofficial eighth project titled *Open House / Open Access*, this project explores multisensory and experimental wayfinding through the exhibition, and one that enables *Take Hold of the Clouds* to live on beyond its physical form.

The exhibition was conceived by Tara McDowell, Director of Curatorial Practice at Monash Art, Design and Architecture, and co-curated with Fleur Watson, Open House Melbourne's Executive Director.





## THIS IS PUBLIC IN-PERSON ATTENDANCE—482 ONLINE—155

This is Public—a marathon speaker series—marked the Weekend’s ‘official’ opening. Contributors presented their practice and research in response to the theme of Built/Unbuilt and considered how to recognise the pre-histories inherent in the buildings, spaces and landscapes of the city. The result was a rich and diverse range of presentations that explored ways in which cultural memory and knowledge could be revealed and registered in our built environment—now and into the future.

Speakers included architect Kerstin Thompson and museum director Jayne Josem discussing the recently-completed Melbourne Holocaust Museum—an adaptive re-use of the former century-old building that has been significantly extended to re-imagine civic and educational role of the museum; followed by Amy Muir and Mark Jacques discussing their collaborative process in designing the Victorian Family Violence Memorial—a landscape recognising the experiences of those affected by family violence.

Boon Wurrung senior Elder N’arwee’t Dr Carolyn Briggs AM, Indigenous architect Jefa Greenaway, and non-indigenous academics Dr Christine Phillips and Jock Gilbert from RMIT School of Architecture & Urban Design’s Ngulu team led an important discussion to explore how we can register Indigenous knowledges in the built environment and move toward the design process as an act of reconciliation.

This is Public closed with a discussion between Samaneh Moafi (via live link from London) in conversation with RMIT academic Caitlyn Parry and OHM President Stuart Harrison on the deeply important and impactful work and research of London-based research collective Forensic Architecture (FA) culminating with a screening of FA’s extraordinary and confronting research film *Cloud Studies* (2021).

## DESIGN: BUILDING ON COUNTRY IN-PERSON ATTENDANCE—448

In response to Professor Paul Memmott and Alison Page’s book *Design: Building on Country*, this public conversation with the authors explored the future of Australia’s built environment when it responds to the essence of Country and its people. The authors were joined by Dr Christine Phillips (Senior Lecturer, RMIT Architecture Program), Jock Gilbert (Program Manager, RMIT Bachelor of Landscape Architecture Program) and Beau de Belle (Gamilaraay architecture graduate/VC Indigenous Pre-Doctoral Fellow at RMIT University) for this talk at The Capitol—RMIT.

The event builds upon last year’s talk ‘Designing with Country’ and forms part of a speaker series presented by RMIT Architecture & Urban Design’s Reconciliation Ngulu team.

## HERITAGE ADDRESS IN-PERSON ATTENDANCE—289 ONLINE—685

The July program culminated at Federation Square with the annual 2022 Heritage Address delivered by Katrina Sedgwick OAM. Speaking in the context of her newly appointed role as the CEO of Melbourne Arts Precinct Corporation (MAP Co), Sedgwick’s deeply researched and inspiring lecture reflected on historical and contemporary precedents for cultural centres in Australia and overseas, her impactful work with ACMI and her emerging vision for Map Co’s remit. She proposed how we might collectively consider ‘future heritage’ for Melbourne’s cultural precinct as we embark upon a time of significant development and investment. The lecture was followed by a conversation drawing out the themes in the Address and moderated by OHM President, Stuart Harrison, with live questions from the audience.

## MODERN MELBOURNE: PETER ELLIOTT IN-PERSON ATTENDANCE—198 ONLINE—857

The July Weekend opened with the premiere screening of *Modern Melbourne* featuring Peter Elliott AM, one of our most celebrated architects and winner of the Australian Institute of Architects Gold Medal in 2017. It examines Elliott’s exploration of architecture as a form of ‘urban acupuncture’—a dexterous, responsive and topographic approach to the relationship between architecture and the city. Held at ACMI’s Cinema 2, the screening was followed by a panel discussion moderated by Heritage Council of Victoria’s (HCV) Chair Professor Phillip Goad with special guests Dimity Reed, Katelin Butler and Jon Clements.

*Modern Melbourne* was a key highlight in the Open House Bendigo program. This regional premiere was followed by an in-conversation facilitated by HCV’s Professor Phillip Goad with OHM’s Board President Stuart Harrison and Executive Director Fleur Watson in the stunning heritage Star Cinema. The documentary has made a valuable addition to our online library and continues to be watched on-demand.

*This episode of Modern Melbourne was made possible by the generous support of Peter Elliott Architecture & Urban Design and the Heritage Council of Victoria, with support from the Victorian Government through Creative Victoria.*

**MAKING HOME (OHM+OHB)**  
**IN-PERSON ATTENDANCE—253**  
**ONLINE—178**

Thoughtfully curated by Tania Davidge, Making Home is shining a light on social and affordable housing and the importance of its delivery as part of a broader infrastructure of care. The series interrogates how architects, housing providers and local government are working to make a difference across Victoria.

Three talks were programmed across the July Weekend: Common Ground Housing | More than a Home and A Design Guide for Older Women's Housing were held in Melbourne School of Design's (MSD) Japanese Room; and Queen Victoria Market Munro Precinct | Affordable Housing and the City was held at the Munro Site itself. Each explored unique aspects of the need for and value in designing a more inclusive city.

The series made its regional debut as part of Open House Bendigo. Making Home: Social & Affordable Housing in Regional Victoria brought together Rachel Gellatly of Haven: Home, Safe (HHS), Clare Cousins of Clare Cousins Architects and Toby Dean Nightingale Housing to unpack what public and community housing looks like in regional Victoria and the key concerns that drive its delivery. A lively and engaging panel discussion with questions from the audience examined how together we can bridge the housing divide. These talks have established a strong foundation for continuing this series into the future and exploring the range of avenues to achieving more inclusive, caring communities.

**KOORIE HERITAGE TRUST X  
OPEN HOUSE MELBOURNE MAP**

First developed in 2017, this map was intended as a starting point to recognise just some of the many sites of Victorian First Nations significance found across Naarm (Melbourne). The highlighted locations include sites of intangible cultural heritage, contemporary First Nations architecture and design, commemorative markers, local Aboriginal organisations and important historic and political sites. It represents the past, present and future of Naarm.

Printed alongside a snapshot of July Weekend program highlights with the full map and list of 2022 buildings on the reverse, this map was available as a fold-out hardcopy or via downloadable PDF on our website. Designed by Letoya Muraru with sites selected by Jefa Greenaway, the map has been developed in a continuing partnership between Open House Melbourne, the Koorie Heritage Trust, and Indigenous Architecture and Design Victoria.



**• JULY WEEKEND PROGRAM STATS\***

COLLABORATORS:

**217**  
PROGRAMS IN TOTAL

**79**  
NEW COLLABORATORS

**138**  
RETURNING COLLABORATORS

**100%**  
WOULD CHOOSE TO PARTICIPATE IN THE  
OPEN HOUSE MELBOURNE WEEKEND AGAIN  
NEXT YEAR

VISITORS:

**23%**  
VISITORS ATTENDING AN OHM EVENT FOR  
THE FIRST TIME

**96%**  
AGREED THAT THE PROGRAM CREATED  
A SENSE OF CIVIC PRIDE AND ACTIVE  
CITIZENSHIP

**98%**  
SAID OHM PROVIDED A UNIQUE AND  
VALUABLE OPPORTUNITY TO DIRECTLY  
ENGAGE WITH ARCHITECTURE IN THE CITY

# OPEN HOUSE MELBOURNE BUILDING LIST 2022

## CITY OF MELBOURNE

- 1 **41 St Andrews Place: Victorian Academy of Teaching and Leadership**  
Designing Architects, 2022; Arena Builder, 2022  
41 St Andrews Place, East Melbourne 3002
- 2 **80 Collins**  
Woods Bagot, Melbourne 3000
- 3 **603 Queensberry Street North Melbourne (Originally 'Stas School 307')**: Victorian Academy of Teaching and Leadership  
Henry Bastow, 1882; Maddison Architects, 2012  
603 Queensberry Street, North Melbourne 3081
- 4 **ACMI**  
LAB Architecture and Bates Smart, 2022; BKK Architects and Second Story, 2021  
Federation Square, Flinders Street, Melbourne 3000
- 5 **Aiken Gallery of the Kett Optometry Museum**  
Read Partnership, 1988; The Curator, 2019  
154-156 Cardigan Street, Carlton 3053
- 6 **Albanian Mosque, Carlton North**  
Dougherty Architecture, 1968  
165 Drummond Street, Carlton North 3054
- 7 **Army Medical Corps Drill Hall**  
George Hilditch, 1938  
233 Colwell St, Melbourne 3000
- 8 **Around the Block in Docklands—Layers and Levels**  
Denton Corker Marshall, Lovell Chen, 2019-2022  
Hasell  
655 Collins St, Docklands 3008
- 9 **Artists Residence—Brewery Res**  
Smith & Johnson, 1842-1923  
188 Collins Street, Melbourne 3000
- 10 **ArtPlay and the Future of Toys Exhibition**  
Bry & Marn, Island Pavilion Exhibitions, Melbourne 3000
- 11 **Arts Centre Melbourne's Interior Design and Public Art Tour**  
City of Melbourne, 1959  
100 St Kilda St, Melbourne 3004
- 12 **BETA by 5TH BNK at Manover House**  
Sibling Architecture, 2021  
66 City Road, Southbank 3006
- 13 **Boyd Community Hub**  
207 City Road, Southbank 3006
- 14 **Catholic Theological College**  
William Wardell, 1970; Gregory Burgess, 1999  
278 Victoria Parade, East Melbourne 3002
- 15 **City of Melbourne Tour: Get to Know The Greenline**  
(Self-led)  
Various architects  
Yarra River Birrarung north bank—between Birrarung Marr and the Docklands
- 17 **City of Melbourne Tours: Pocketbook Play Spaces**  
(Self-led)  
City of Melbourne  
Various locations
- 18 **CO.AS.IT. Museo Italiano Exhibition Guided Tours**  
199 Faraday Street, Carlton 3053
- 19 **CO.AS.IT. Museo Italiano Online Presentation**  
199 Faraday Street, Carlton 3053
- 20 **CO.AS.IT. Museo Italiano Self-Guided Tour**  
199 Faraday Street, Carlton 3053
- 21 **CO.AS.IT. Museo Italiano Virtual Reality Tour**  
199 Faraday Street, Carlton 3053
- 22 **Collins Arch Public Realm and Market Street Park**  
OCULUS, Woods Bagot and SHoP Architects, 2020  
447 Collins Street, Melbourne 3000
- 23 **Government House**  
William Wardell, 1872  
(Government House Drive, Melbourne 3004
- 24 **Gulfport and Hardware Lane—An Historian's Tour**  
Various architects  
Gulfport and Hardware Lane, Melbourne 3000
- 25 **Hayball Studio + Venice Biennale**  
Hayball, 2020  
Level 1, 250 Flinders Ln, Melbourne 3000
- 26 **Hyatt Centric Melbourne**  
Architects, 2021  
25 Downs Street, Melbourne 3000
- 27 **James Walk: Let's Walk and Talk About Public Art Around the Backyard of State Parliament House**  
Parliament House, Spring St, East Melbourne 3002
- 28 **Just Add Public Life: Repairing Southbank**  
Homer East, 400 St Kilda Road, Southbank 3004
- 29 **Koorie Heritage Trust**  
Lyons with Indigenous Architecture and Design Victoria (IADVI), 2018  
The Yarra Building, Federation Square, Flinders Street and Swinburn Street, Melbourne 3000
- 30 **Library and Community Hub at The Dock**  
Clare Design and Hayball, 2014  
107 National Maritime Promenade, Docklands 3008
- 31 **Little Hall**  
Hayball, 2020  
107 National Maritime Promenade, Docklands 3008
- 32 **Market Lane**  
Elenberg Fraser, 2021  
68 Collins Street, Docklands 3008
- 33 **Melbourne Park**  
NH Architecture, 2021  
Melbourne & Olympic Parks, Olympic Boulevard, Melbourne 3001
- 34 **Melbourne Square**  
COX Architecture, 2022  
93-119 Kavanagh St, Southbank 3006
- 35 **Melbourne Town Hall Tours**  
Read and Barnes Architects and Surveyors, 1867  
90-100 Swinburn Street, Melbourne VIC 3000
- 36 **Mission to Seafarers Heritage Tours**  
Water Butler, 1916-1919  
77 Flinders Street, Docklands 3008
- 37 **NH Architecture Open Studio**  
Denton Corker Marshall, 1980; NH Architecture, 2020  
715-727 Flinders Lane, Melbourne 3000
- 38 **Old Customs House—Unbuild and Re-Imagine**  
Peter Kerr, John James Clark and Arthur Ebdon Johnson, 1841-1873  
400 Flinders St, Melbourne 3000
- 39 **Old Treasury Building**  
John James Clark, 1858-1862  
30 Spring Street, East Melbourne 3002
- 40 **OlderReet**  
J.A.B. Koch, 1887; Oakes Addison and Kemp, 1888; William Pitt, 1889; Grimshaw with Carr, 2020  
477 Collins Street, Melbourne 3000
- 41 **Paragon: Sanctuary in the City**  
Fender Katsalidis, Melbourne 3000
- 42 **Parliament House**  
John George Knight and Peter Kerr, 1855  
George Street, Melbourne 3002
- 43 **Port of Melbourne Boat Tours**  
58 Harbour Promenade, Victoria Harbour, Docklands 3008
- 44 **Queen and Collins**  
William Wardell, 1883-87; William Pitt, 1890; Piddell-Hart Leasmoor, 1930-93; Allon Lovell, 1990-9; Kerstin Thompson Architects, BVN, Lovell Chen, 2019-2022  
180 Collins Street, Old Queen & Collins St, Melbourne 3000
- 45 **Queens Place: Elevated Lifestyle at Urban Scale**  
Fender Katsalidis and COX Architecture  
150 Queen St, Melbourne 3000
- 46 **Rebuild La Mama**  
George J. Clarke, 1983; Meg White and Cottes Parker Architects, 2019-2021  
205 Faraday Street, Carlton 3053
- 47 **River Studios**  
41-53 Sims St, West Melbourne 3003
- 48 **Royal Botanic Gardens—Plant Craft Cottage**  
Henry Glen, 1850  
Melbourne Gardens, Gate H, Alexandra Ave, South Yarra 3141
- 49 **Shaping Swinburn Street: A Tour of AEM Architecture's Iconic Melbourne Projects**  
AEM Architecture  
Walking tour featuring Shilve of Remembrance
- 50 **Sharing Schools, Building Communities Exhibition**  
John Wardle Architects and NADAAA, 2016  
100 Gordon Street, Parkville 3052
- 51 **St Paul's Cathedral**  
William Butterfield, 1880-81; John Barr, 1926-31  
200 Flinders Lane, Melbourne 3000
- 52 **St Thomas Aquinas Church**  
Kempson and Conolly, 1915; Thomas Payne, 1954  
43 Spring Street, South Yarra 3141

- 53 **State Library Victoria**  
Joseph Reed, 1856; Architect and Schmidt Hammer Lassen, 2020  
322 Swanston St, Melbourne 3000
- 54 **Techno Architecture + Interior Design Studio**  
Techno Architecture and Interior Design  
27 St Bouverens Street, Carlton 3053
- 55 **Testing Grounds Unbuilt**  
Milla Cottin, 2016, 2022  
271 M'Clintock Street, St. Melbourne 3000
- 56 **The Capitol, RMIT University**  
Marion Mahony Griffin and Walter Burley Griffin, 1924.  
113 Swinerton Street, Melbourne 3000
- 57 **The Johnston Collection**  
John McEwen, 1860  
192 Wellington Parade, East Melbourne 3002
- 58 **The Muro Site and Life Between Buildings at the Muro**  
Eric Conzemsky Hub | City Room  
Six Degrees Architects and Bates Smart, 2022  
Muro Arts, c/o Terry and Queen Street (opposite Queen Victoria Market), Melbourne 3000
- 59 **The Scots' Church Melbourne**  
David Mitchell, 1871; Henry H Kamp, 1916  
Colwell and Russell St, Melbourne 3000
- 60 **Trades Hall: A Living History Tour**  
Read & Barnes 1870-1926, Lovell Chen 2019-24  
Victoria Street, Carlton South 3053
- 61 **Veterans Public Art Trail**  
Walking tour of Melbourne  
Various locations
- 62 **Victorian Artists Society**  
Richard Spaight, 1892  
233 Colwell Street, Melbourne 3000
- 63 **Victorian Family Violence Memorial Tour**  
MUR and OPENWORK, 2022  
St Andrews Place Reserve, Cnr St Andrews Place and Landdowne Street, East Melbourne 3002
- 64 **Victorian Quaker Centre**  
Nerenga Reed Architecture and p4 architects, 2020  
448 William Street, West Melbourne 3003
- 65 **Wesley Church**  
Cnr St. Street, Melbourne 3000
- 66 **Wesley Place**  
COX Architecture and OCULUS, 2018  
81 Lygon Street, Melbourne 3000
- 67 **Wesley Place Public Realm**  
COX Architecture and OCULUS, 2021  
81 Lygon Street, Melbourne 3000
- 68 **Young and Jackson Hotel**  
John Flannigan, 1875; Richard & Whittaker, 1921  
1 Swinerton Street, Melbourne 3000

## UNIVERSITY OF MELBOURNE

- 69 **Blot! Institute: Innovative from the Outside-In**  
Designing, 2016 and 2018  
100 Stephans Road, Parkville 3052
- 70 **Emu Sky at Old Quad**  
Francis Maloney White, 1857; Lovell Chen, 2019  
Old Quad, The University of Melbourne, Grattan Street, Parkville 3052
- 71 **Granger Museum**  
George and Drummond Architects, 1935; Lovell Chen, 2006  
University of Melbourne, 13 Royal Parade, Parkville 3052
- 72 **Greg Burgess: At the Coalface**  
Noel Shaw Gallery, Level 1, Ballieu Library, Professors Walk, University of Melbourne, Parkville 3052
- 73 **Melbourne Connect**  
Woods Bagot and Hayball, 2020  
Melbourne Connect, Carlton 3053
- 74 **Melbourne Connect: Cultural Collection**  
Woods Bagot, 2020; Hasell, 2021  
700 Swinburn Street, Carlton 3053
- 75 **Melbourne Connect: Digital Twin Solutions (D-Lab)**  
Hasell, 2022  
700 Swinburn Street, Carlton 3053
- 76 **Melbourne Connect: Environmental Graphics**  
Woods Bagot, 2020; Hasell, 2021  
700 Swinburn Street, Carlton 3053
- 77 **Melbourne Connect: Faculty of Engineering and Information Technology**  
Woods Bagot, 2020; Hasell, 2021  
700 Swinburn Street, Carlton 3053
- 78 **Melbourne Connect: Interactive Technologies Lab**  
700 Swinburn Street, Carlton 3053
- 79 **Melbourne Connect: Teletra Creator Space**  
Hasell, 2021  
700 Swinburn Street, Carlton 3053
- 80 **Melbourne School of Design**  
John Wardle Architects and NADAAA, 2016  
230 Grattan Street, Parkville 3052
- 81 **University of Melbourne, Southbank Campus: Fines and Sidney Sydney Gallery**  
Six Degrees Architects, 2001  
230 Grattan Street, Parkville 3052
- 82 **University of Melbourne, Southbank Campus: The Stanley**  
Six Degrees Architects, 2019  
26 Grant Street, Southbank 3006
- 83 **University of Melbourne, Southbank Campus: The Ian Potter**  
Kerstin Thompson Architects, 2018  
26 Grant Street, Southbank 3006
- 84 **University of Melbourne, Southbank Campus: The St Kilda Synagogue**  
Peter Kerr, Kerstin Thompson Architects, 2018  
12 Charles Street, St Kilda 3182
- 85 **Gasworks Arts Park**  
Grant Anon Architects, 2004/2005  
21 Gasworks Street, Albert Park 3008
- 86 **Guided Tour: South Melbourne in 1906: Retail and Commerce**  
Various architects  
Clarendon Street, South Melbourne
- 87 **Guided Walk: Clarendon Street's Heritage Architecture and the Emerald Hill Estate**  
William Pitt, Walter Scott Law, Terry and Oakes, Charles Webb, 1988; Peter Carmichael, 1976; Williams Soag Architects, 2001  
246 Park Street, South Melbourne 3037
- 88 **Clarendon Street Street Self-Guided Tour**  
Various architects heritage listed precinct 1880s onward  
Clarendon Street, South Melbourne 3000
- 89 **Explore the St Kilda Synagogue**  
J.Pattell, 1920  
12 Charles Street, St Kilda 3182
- 90 **Explore the St Kilda Synagogue**  
The Synagogue Building 87B, St Lovells Street, Southbank 3006
- 91 **Melbourne Camera Club**  
Adomson and McKean, 1975  
254-256 Farners Street, South Melbourne 3008
- 92 **St Kilda Cemetery**  
Dunstan Street, St Kilda East 3183
- 93 **St Kilda Foreshore Walk**  
1891  
The Esplanade, St Kilda 3182
- 94 **Talk and Tour: The See Yee Temple: Its History and Heritage**  
George Wharton, 1886; Harold Devoldres Anonard, 1901  
76 Ragnan St, South Melbourne 3209
- 95 **Temperance Hall**  
Enafield 1887 Total Abstinence Society, 1865  
199 Napier Street, South Melbourne 3209
- 96 **Transurban's Habitat Filter**  
Drysdale Myers and Dow, 2016  
Power Street and ramp from the Domain Tunnel, Melbourne 3000
- 97 **Ullmarra and ANZCA House on Bonin Wurrung Country**  
John A.B. Koch, 1889; Norman Day, 1999  
180 Victoria Street, Melbourne 3004
- 98 **The Victoria Prize Centre**  
Brearley Architects & Urbanists (BAU) and Grant Anon Architects, 2021  
76 St Flinders Street, St Kilda 3182
- 99 **Chapel OH Chapel**  
Thomas & Croach, 2011  
12 Little Chapel Street, Pratzon 3181
- 100 **Come House and Gardens**  
Lower Hall Anglican Grammar School (Earlsford Hall) Lawson and Gray, 1890  
17 Leslie Road, Essendon 3040
- 101 **Melbourne Bound: The City in Books**  
Melbourne Design Studios (MDS), 2021  
300 K Road, Wertheim South 3030

- 102 **Date-A-Sculpture: Speed Dating at the Dulgin Studio**  
92 Burke Rd, Malvern East 3145
- 103 **EMAGN THSI Lang House**  
Austin Maynard Architects, 2022  
Lang House, 11 Lang St, South Yarra 3141
- 104 **Firestation Print Studio**  
Oakden & Ballantine, 1904  
2 Willis Street, Armadale 3143
- 105 **Loreto Clendon Centre**  
John Sprunt, 2022  
271 M'Clintock Street, Carlton 3142
- 106 **Loreto Mandeville Centre**  
Architects  
10 Mandeville Crescent, Torak 3142
- 107 **Mandeville Hall**  
Joseph Reed, 1867; Charles Webb, 1877  
12 Mandeville Crescent, Torak 3142
- 108 **National Institute of Circus Arts (NICA)**  
Bates Smart Architects, 2022; COX Architects, 2007  
85 Chapel St, Prahran 3181
- 109 **Northbrook and the Stonnington Heritage Centre**  
Charles D'Elia, 1989  
107 High Street, Melbourne 3144
- 110 **Prahan Arcade—Facade Conservation**  
RBA Architects & Conservation Consultants, 2022  
85 Chapel St, Prahran 3181
- 111 **Prahan Square**  
Lyons and ASPECT Studios, 2019  
145 Sturt Street, Prahran 3181
- 112 **St James Anglican Church Glen Iris**  
Bogle & Banfield, 1995  
160 High Street, Glen Iris 3146
- 113 **Umbra—The Country Women's Association of Victoria Inc.**  
1875  
3 Lancel Road, Torak 3142

## CITY OF BOROONDARA

- 114 **Annie Hughton Centre (AHC)—Fintona Girls' School**  
Lyons and ASPECT Studios, 2021  
79 Wilson Street, Boroondara 3083
- 115 **Auburn Uniting Church Complex**  
Alfred Dunn, 1889  
145 Sturt Street, Boroondara 3083
- 116 **Canberwell Civic Precinct**  
James Gail, 1890-91; Irwin and Stevenson, 1924; Mockridge Stahle and Mitchell, 1978  
8 Lygon Street, Canberwell 3174
- 117 **EMAGN THSI Artistry Collective**  
Arty Architects, 2021  
Arty Architects, Auburn Road, St Albans Rd, Hawthorn 3122
- 118 **Former Hawthorn Tram Depot**  
Leonard Flanagan, 1915  
Hawthorn Arts Centre, Hawthorn 3122
- 119 **Hawthorn Arts Centre**  
John Benwick, 1889; Piddie Thorp Architects, 2013  
360 Burwood Road, Hawthorn 3122
- 120 **Keew Court House**  
G.W. Watson, 1888  
188 High Street, Kew 3101
- 121 **Lyon House Museum Galleries**  
Corbett Lyons, 2019  
27 Cottam Road, Kew 3101
- 122 **St Faith's Anglican Church Burwood**  
Mockridge, Stahle and Mitchell, 1978  
4-8 Charles Street, Glen Iris 3146
- 123 **Tay Creagan**  
Robert Bryan Purchas, 1893  
30 Yarra Street, Hawthorn 3122
- 124 **Villa Alba Museum**  
Unknown architect, 1882-1884  
44 Walmer Street, Kew 3101

## CITY OF MARYBOROUGH

- 125 **296 Whitehall**  
G.T. Architecture, 2021  
296 Whitehall Street, Clayton 3168
- 126 **Enclindown: How to Research Your House's History**  
Terry and Oakes, 1976  
46 Nelson Street, Footscray 3011
- 127 **Footscray Town Hall**  
Joseph Pottler, 1936  
61 Nelson Street, Footscray 3011
- 128 **Heavenly Queen Temple**  
Steven Kwong, 2018-2020  
27 Nelson Street, Footscray 3011
- 129 **Jack's Magazine**  
William Wardell, 1878  
Melbourne House, Maryborough 3032
- 130 **Kindred Studios Creative Spaces Tour**  
211 Main Street, Maryborough 3032
- 131 **Living Museum of the West**  
MLMW & Heritage Victoria & Parks Victoria 2003; MLMW, Heritage Victoria & ASPECT Studios, 2020  
200 Exhibition Walk, Clayton 3168
- 132 **Wah Street Archive and Residence Revealed**  
Robin Boyd, 1958  
48 Exhibition Walk, Clayton 3168
- 133 **Woodside Building for Technology and Design**  
Taylor Cullity Lethlean and Melbourne Partners, 2019  
20 Exhibition Walk, Clayton 3168

## CITY OF HOBBSONS BAY

- 134 **Altona Homestead**  
Alfred Langhorne, mid 1840s  
108 Queen St, Altona 3085
- 135 **Blunt's Boat Shed**  
Unknown architect, 1913  
160 Nelson Place, Williamstown 3016
- 136 **Former Williamstown Morgue—Seaworks Maritime Museum**  
James Balmain, 1859  
82 Nelson Place, Williamstown 3016
- 137 **Forest Street Passive House**  
Allerrett Design, 2021  
13 Forest Street, Spotswood 3015
- 138 **HMAS Castlemaine**  
New Department of Defence, Melbourne Harbour Trust Shipyard  
200 St. Williams, Williamstown 3016
- 139 **Modscape's Modular Design Hub**  
Modscape, 2006  
433 Stock Street, Brooklyn 3012
- 140 **Old Laverton School**  
43 Kora St, Altona Meadows 3028
- 141 **Park Life**  
Architecture Architecture, 2019  
Williamstown North, full address available on booking  
Williamstown North, full address available on booking
- 142 **Williamstown Town Hall Open House and Tour**  
Porter & Bennett, Giles, Finlay & Morley in 1918-1924 and Theo Kerlidis K2O Architecture, 2008-2016  
104 Ferguson Street, Williamstown 3016

## NORTH

- 143 **Alicia Frankovich's The Eye at Brunwick Baths**  
Alicia Frankovich, 2016  
206 Brunwick Street, Brunswick 3066
- 144 **Architects Guide to Collingwood Yards—Tour and Conversation**  
Percy Everett, 1948; Fieldwork, 2020  
26 Johnston Street, Collingwood 3066
- 145 **Bundoora Homestead Art Centre Heritage Tour**  
Sydney Herbert Wilson, 1899  
771 Main Street, Bundoora 3083
- 146 **Cafe Fats**  
Best Overend of Taylor-Sollau & Overend, 1936; Richard H. Jones, 1950  
17 Cassellina Place, Melbourne 3000
- 147 **Escape to Pentridge**  
ASPECT Studios & NH Architecture, Buchan Group, Electrolight, Sue Hodges Production SHP, PTA Landscapes & Creative Arts, 2019  
123 Pentridge Street, Melbourne 3000
- 148 **Essendon Incinerator**  
Waterbury Griffin & REICO, 1929  
200 Melbourne Street, Aberfeldie 3067
- 149 **FIGR Pop-Up House**  
FIGR Architecture Studio, 2020  
55 Johnston Street, Collingwood 3040
- 150 **Gleeray Community Hub**  
Designinc, 2022  
200 Johnston Street, Collingwood 3040
- 151 **Good Shepherd Chapel Through Time**  
Robert Simoni Architects  
13 Malvern Street, Brunswick 3066
- 152 **HIST 01 Passive House**  
Melbourne Design Studios (MDS), 2021  
300 K Road, Wertheim South 3030
- 153 **Islamic Museum of Australia**  
Dougherty Architecture, 2011  
16A Anderson Road, Thornbury 3071
- 154 **Jewell Station Village Tours by NEOMETRO**  
BKK Architects, 2021; Fieldwork, MAArchitects 2010; Lovell Chen and GLAS, 2019  
Jewell Railway Station, Brunswick 3066
- 155 **John Wardle Architects Studio Open Day**  
John Wardle Architects, 2012, 2022  
25 Rokeby St, Collingwood 3066
- 156 **Lower Hall Anglican Grammar School (Earlsford Hall)**  
Lawson and Gray, 1890  
17 Leslie Road, Essendon 3040
- 157 **Melbourne Bound: The City in Books**  
Melbourne Design Studios (MDS), 2021  
300 K Road, Wertheim South 3030

## CITY OF STONNINGTON

- 158 **Lower Hall Anglican Grammar School (Earlsford Hall)**  
Lawson and Gray, 1890  
17 Leslie Road, Essendon 3040
- 159 **Melbourne Bound: The City in Books**  
Melbourne Design Studios (MDS), 2021  
300 K Road, Wertheim South 3030

- 160 **Neo Nomads: Beyond Hybrid Work**  
Footscray Studio, 2009  
404 George St, Brunswick 3066
- 161 **Nightingale 2 Park Hill**  
Six Degrees Architects, 2019  
High Street, Brunswick 3066
- 162 **Northcote Town Hall Art Centre**  
George R. Johnson, 1888  
High Street, Brunswick 3066
- 163 **Regenerating & Refurbishing Civic Landscapes for Future Generations**  
Joseph Pottler, 1937; Gray Pulsford, 2021  
160 Colwell St, Collingwood 3066
- 164 **Site Unseen**  
Sean Godsell Architects  
404 George St, Brunswick 3066
- 165 **Thornbury Townhouses**  
Fowler and Ward, 2019  
1918 Miller Street, Thornbury 3071
- 166 **Town Hall Broadmeadows**  
Murry, Foster & Walsh 1944, Kerstin Thompson Architects 2019  
10 Donnelton Road, Broadmeadows 3047
- 167 **Walking Tour of JWA Collingwood Projects**  
John Wardle Architects, 2021  
14 Collingwood St, Collingwood 3066
- 168 **Woodlands Historic Homestead**  
Peter Thompson, 1843  
Woodlands Drive, Geelong 3038

## SOUTH

- 169 **Billion Historic Mansion**  
E. Evan Smith, 1928  
26 Mallick St, Brighton 3186
- 170 **Brighton General Cemetery**  
26 Mallick St, Brighton 3186
- 171 **Brighton Municipality Offices & Council Chambers**  
Kevin Knight, John Connell and Associates and Prentice Builders Pty Ltd, 1961  
15 Southbank Street, Brighton 3186
- 172 **Brighton Town Hall**  
Wilson and Bewick, 1886  
Cnr Wilson Carpenters Street, Brighton 3186
- 173 **Bunfil Place**  
F.Patrick Northcote Drive, Name Warren 3805
- 174 **Carum Station**  
COX Architecture, 2020  
Johnston Ave and Nepean Highway, Carum 3197
- 175 **Chelsea Court House**  
E. Evan Smith, 1928  
6 The Strand, Chelsea 3196
- 176 **Dandenong Town Hall and Drum Theatre**  
Banks and Hutchins, 1920; Williams Ross Architects, 2006  
225 Lonsdale Street, Dandenong 3178
- 177 **Glen Elgin Town Hall**  
Sidney Smith, 1884; Alexander Rankin, 1990; Goldsmith and Jenkin, 1930; Ivan Rijavec, 1990  
Cnr Glen Elgin & Hawthorn St, Collingwood 3162
- 178 **Melbourne Holocaust Museum**  
Kerstin Thompson Architects, 2022  
13 Nelson St, Melbourne 3000
- 179 **Medton Heritage Buildings & Gardens**  
Edmondson, 1880  
1800 Victoria St & Come Ple, West Melbourne 3184
- 180 **Monash Learning and Teaching Building**  
John Wardle Architects and ASPECT Studios, 2018  
10 Monash Square, Clayton 3168
- 181 **Monash Makerspace**  
Brand Architects, 2019  
25 College Road, Clayton 3168
- 182 **Monash Robotics Research Facility**  
Studio Bright and AKAS, 2021  
18 Nelson St, Melbourne 3000
- 183 **Monash Tech School**  
Brand Architects, 2019  
120 Arcoona Highway, Clayton 3168
- 184 **Old Bakery Museum, Mentone**  
Unknown architect, 1924  
2 Old Bakery Lane, Mentone 3194
- 185 **Springvale Community Hub**  
Lyons and Rush Wight Associates, 2020  
3 Melbourne Circus, Springvale 3171
- 186 **The Ian Potter Centre for Performing Arts**  
Eggleston MacDonald and Secomb, 1967; Peter Elliott Architecture + Urban Design, 2018  
48 Exhibition Walk, Clayton 3168
- 187 **Wah Street Archive and Residence Revealed**  
Robin Boyd, 1958  
48 Exhibition Walk, Clayton 3168
- 188 **Woodside Building for Technology and Design**  
Taylor Cullity Lethlean and Melbourne Partners, 2019  
20 Exhibition Walk, Clayton 3168

## EAST

- 189 **Box Hill Town Hall**  
J.S. Gessler and J.C. Aisbett  
1022 Whitehorse Road, Box Hill 3108
- 190 **Brew Tower Museum at Trillicka**  
George Warton and William Pitt, 1883  
412 Victoria Parade, East Melbourne VIC 3002
- 191 **Burwood Bricksworks Shopping Centre**  
70 Middleborough Road, Burwood East 3119
- 192 **MLC Nicholas Learning Centre and Principal's Terrace**  
Taylor Cullity Lethlean and Melbourne Partners, 2019  
207 Barkers Rd, Kew 3101
- 193 **Mount Burnett Observatory**  
Monash Dome, 1972  
420 Paternoster Road, Mount Burnett 3781
- 194 **Old Heidelberg Courthouse, Refurbished**  
JB Cohen with W Mackay, 1905  
15 Joka Street, Heidelberg 3084
- 195 **Skyrail—Cascaded to Dandenong Level Crossing**  
Renovated Project & Liaser Park  
ASPECT Studios and COX Architecture  
Suburb of Carnegie, (Maroonston), Hughesdale, Clayton & Noble Park
- 196 **St George's**  
Robin Boyd & Frederick Rumburg, 1964  
47-49 Whitehorse Road, Northcote 3070
- 197 **Strathdon House**  
Water John Fanshawe, 1883; Charles Macken Sme and Mary Lillian McLaren, 1918; Lovell Chen, 2021  
448 Springvale Road, Forest Hill 3131
- 198 **Wangaratta Offices, Richmond**  
MAArchitects, 2020  
45 Wangaratta Street, Richmond 3121

## WEST

- 199 **Werribee Park Mansion**  
Unknown architect, 1877  
320 K Road, Wertheim South 3030

## SPRING PLACE

- 200 **167 Casselden Place**  
Unknown architect, 1881-1901  
17 Casselden Place, Melbourne 3000
- 201 **168 Lonsdale St**  
John Wardle Architects, 2006  
60 Lonsdale St, Melbourne 3000
- 202 **169 Lonsdale St**  
John Wardle Architects, 2006, 2018; Bates Smart, 2019  
60 Lonsdale St, Melbourne 3000
- 203 **170 Lonsdale St**  
John Wardle Architects, 2006, 2018; Bates Smart, 2019  
60 Lonsdale St, Melbourne 3000
- 204 **171 Lonsdale St**  
John Wardle Architects, 2006, 2018; Bates Smart, 2019  
60 Lonsdale St, Melbourne 3000
- 205 **172 Lonsdale St**  
John Wardle Architects, 2006, 2018; Bates Smart, 2019  
60 Lonsdale St, Melbourne 3000
- 206 **173 Lonsdale St**  
John Wardle Architects, 2006, 2018; Bates Smart, 2019  
60 Lonsdale St, Melbourne 3000
- 207 **174 Lonsdale St**  
John Wardle Architects, 2006, 2018; Bates Smart, 2019  
60 Lonsdale St, Melbourne 3000
- 208 **175 Lonsdale St**  
John Wardle Architects, 2006, 2018; Bates Smart, 2019  
60 Lonsdale St, Melbourne 3000
- 209 **176 Lonsdale St**  
John Wardle Architects, 2006, 2018; Bates Smart, 2019  
60 Lonsdale St, Melbourne 3000
- 210 **177 Lonsdale St**  
John Wardle Architects, 2006, 2018; Bates Smart, 2019  
60 Lonsdale St, Melbourne 3000
- 211 **178 Lonsdale St**  
John Wardle Architects, 2006, 2018; Bates Smart, 2019  
60 Lonsdale St, Melbourne 3000
- 212 **179 Lonsdale St**  
John Wardle Architects, 2006, 2018; Bates Smart, 2019  
60 Lonsdale St, Melbourne 3000
- 213 **180 Lonsdale St**  
John Wardle Architects, 2006, 2018; Bates Smart, 2019  
60 Lonsdale St, Melbourne 3000
- 214 **181 Lonsdale St**  
John Wardle Architects, 2006, 2018; Bates Smart, 2019  
60 Lonsdale St, Melbourne 3000
- 215 **182 Lonsdale St**  
John Wardle Architects, 2006, 2018; Bates Smart, 2019  
60 Lonsdale St, Melbourne 3000
- 216 **183 Lonsdale St**  
John Wardle Architects, 2006, 2018; Bates Smart, 2019  
60 Lonsdale St, Melbourne 3000
- 217 **184 Lonsdale St**  
John Wardle Architects, 2006, 2018; Bates Smart, 2019  
60 Lonsdale St, Melbourne 3000
- 218 **185 Lonsdale St**  
John Wardle Architects, 2006, 2018; Bates Smart, 2019  
60 Lonsdale St, Melbourne 3000
- 219 **186 Lonsdale St**  
John Wardle Architects, 2006, 2018; Bates Smart, 2019  
60 Lonsdale St, Melbourne 3000
- 220 **187 Lonsdale St**  
John Wardle Architects, 2006, 2018; Bates Smart, 2019  
60 Lonsdale St, Melbourne 3000
- 221 **188 Lonsdale St**  
John Wardle Architects, 2006, 2018; Bates Smart, 2019  
60 Lonsdale St, Melbourne 30



## KULIN MELBOURNE: SITES OF VICTORIAN FIRST NATIONS SIGNIFICANCE

This map was first developed in 2017 and was intended as a starting point to recognise just some of the many sites of Victorian First Nations significance found across Naarm (Melbourne), and is by no means a complete list. The highlighted locations include sites of intangible cultural heritage, contemporary First Nations architecture and design, commemorative markers, local Aboriginal organisations and important historic and political sites. It represents the past, present and future of Naarm.

The map has been developed in a continuing partnership between Open House Melbourne, the Koorie Heritage Trust, and Indigenous Architecture and Design Victoria.

The sites have been selected by Jefa Greenaway, and the map designed by Letoya Muraru. We acknowledge the Traditional Custodians of the land that this map represents: the peoples of the Kulin Nation, and pay our respects to their Elders, past, present and future. This land was never ceded. This map of Naarm demonstrates the ongoing connection of our First Nations communities to land and place that existed before invasion and continues today.

- Kulin Nation Gathering Place**  
Melbourne Cricket Ground  
An important historical gathering place for the people of the Kulin Nation, it sits on what is now known as the grounds of the Melbourne Cricket Ground (MCG). Scar trees can also be found in the adjacent Yarra Park, demonstrating an ongoing Aboriginal occupation of the land.
- The Black Mile**  
Gertrude Street, Fitzroy  
From Nicholson Street to Smith Street this stretch of Gertrude Street has been home to community services and sites of political activism for the Aboriginal people of Victoria.
- You Are, Here Now**  
A commissioned artwork by artist Megan Cope paying homage to the landscape of Yalukit Wilam and the Aboriginal people of the Port Phillip area.
- Pastor Sir Douglas + Lady Gladys Nicholls Memorial**  
Spring Street, Parliament Gardens, Melbourne  
A memorial of two of Australia's most prominent Indigenous Leaders.
- The Moreton Bay Fig Tree**  
Carlton Gardens, Nicholson Street, Carlton  
When bans were enforced on political meetings from the 1920s-1940s this site became a meeting place for the emerging Aboriginal community in Fitzroy.
- Bunjilaka Aboriginal Cultural Centre (Melbourne Museum)**  
Carlton Gardens, Carlton  
Bunjilaka is an Aboriginal cultural centre and keeping place of Aboriginal artefacts. The First Peoples exhibit that opened in 2013 is a co-curated space between Indigenous Elders and Indigenous Museum Victoria staff.
- Lowitja Institute**  
100 Drummond St, Carlton  
Australia's National Institute for Aboriginal and Torres Strait Islander Health Research.
- Standing by Tasmannianerwait and Maulboeyheenner: A commemorative marker**  
Corner Victoria + Franklin Streets, Melbourne  
A commemorative public marker commissioned by artists Brook Andrew and Trent Walker to mark the site where two Aboriginal Tasmanians, Tunnarinnerwait and Maulboeyheenner, became the first people to be publicly executed in Melbourne in 1842.
- The William Barak Building**  
551 Swanston Street, Carlton  
An apartment tower designed by ARM Architecture. The building's facade features the face of important Wurundjeri leader William Barak, which received a mixed public opinion when opening in 2015.
- Ngarrara Place (RMIT University)**  
Chemistry Lane, RMIT University, Melbourne  
Indigenous designed landscape/intervention, building a visible presence and recognition of Aboriginal and Torres Strait Islander peoples at RMIT University.
- Pre-Colonial Red-River Gums**  
Near University Oval, College Crescent, University of Melbourne, Parkville  
The University of Melbourne is home to Red-River gums dating from before European invasion. This surviving landscape invokes imagery of what Kulin Melbourne looked like pre-invasion.
- The Koorie Heritage Trust**  
Yarra Building, Federation Square, Melbourne  
The Koorie Heritage Trust is a community owned and run Indigenous gallery and cultural centre celebrating the continuing journey of the Aboriginal Peoples of South Eastern Australia. The building interior was designed by Lyons Architecture with Greenaway Architects and Indigenous Architecture and Design Victoria to reflect Koorie design and culture.
- Birrarung Wiliam (campsite on the river of mists)**  
Birrarung Marr, along the Yarra River behind Federation Square  
A ground breaking design and interactive installation that re-creates a place of gathering along the Birrarung. This site was created as a place to acknowledge and commemorate all Victorian Aboriginal communities and language groups.
- The Wiliin Garden (The Wiliin Centre for Indigenous Arts and Cultural Development)**  
University of Melbourne, 234 St Kilda Rd, Southbank  
An Indigenous garden located outside of the Wiliin Centre, within the Faculty of the VCA and MCM at the University of Melbourne. This site is a significant contemporary gathering place for the Wiliin Centre Indigenous students and staff.
- Aboriginal Remains**  
Buried within the historic cemetery beneath the Queen Victoria Market, Corner Franklin + William Streets, Melbourne  
This is the site of Melbourne's first official colonial cemetery from 1837-1854, which had a section allocated for Aboriginal remains. It has since become part of the Queen Victoria Market, leaving thousands of unmarked remains still buried beneath the car park.
- Aboriginal Remains (Pre-Invasion Aboriginal Burial Ground)**  
Flagstaff Gardens, Melbourne  
Pre-invasion Aboriginal burial site that now contemporarily commemorates the site of the first settler graves whilst staying silent on the Indigenous history of the site.
- Aboriginal Remains (Reburial site of repatriated Aboriginal remains)**  
Kings Domain, Melbourne  
The Kings Domain resting place holds the remains of 38 Victorian Aboriginal people who were repatriated to the community in 1985 from Museum Victoria, in proceedings led by Uncle Jim Berg, the founder of the Koorie Heritage Trust.

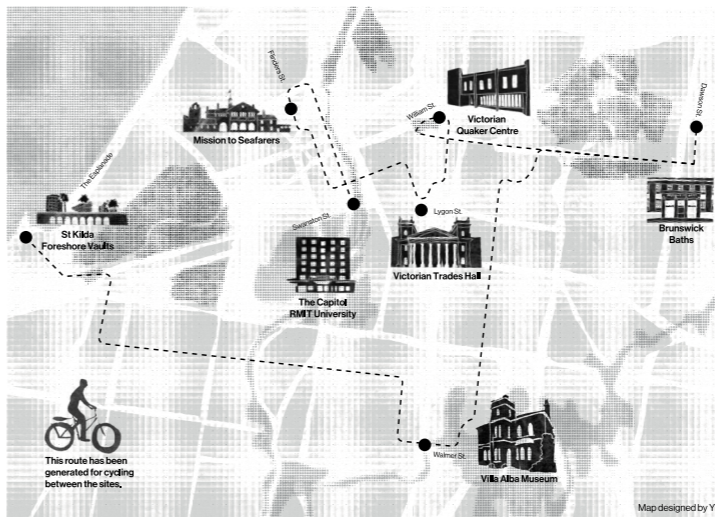

Take Hold of the Clouds  
Map designed by YY

## ACKNOWLEDGEMENT OF COUNTRY

Open House Melbourne programming exists on what always was and always will be the land of the people of the Kulin Nation. We pay our respects to Elders past, present and emerging, as well as to all Aboriginal and Torres Strait Islander people in the wider Naarm/Melbourne community and beyond. Indigenous sovereignty has never been ceded in Australia and we try to be mindful of this in everything we do, given our focus on the modern built environment.

## OPEN HOUSE MELBOURNE JULY WEEKEND BUILT/UNBUILT 30+31 JULY

In 2022—after two years of virtual programming due to the COVID-19 pandemic—Open House Melbourne's July Weekend makes a long-awaited return to physical form to 'open up' a diverse range of heritage and contemporary spaces across the city for the public to experience and encounter.

The overarching theme for this year—**Built/Unbuilt**—seeks to catalyse a city-wide conversation about the future of architecture, landscape and urban design through the lens of the pressing issues facing cities today, including how the built environment contributes to and shapes public life; the relationship between the built and natural world; and how to reveal, reconcile and acknowledge the pre-histories and afterlives of places, spaces and buildings.

**Built/Unbuilt** celebrates the contribution and impact of good design in our built environment yet also explores the city and suburbs at diverse scales and systems—the urban, civic, public, landscape, and interior, as well as those spaces that are 'unbuilt' and in-between.

We reflect upon the atmospheric impact of the built and profile projects that pursue sustainable practices and net-zero outcomes. We also consider the experience and ongoing impact of the pandemic and how extended isolation shapes expectations of how we live, work and gather together in public, community and private spaces.

## TAKE HOLD OF THE CLOUDS

30+31 July  
Distributed over 7 sites across the city

For the July Weekend 2022, Open House Melbourne presents a new curated project **Take Hold of the Clouds**. Created in partnership with Monash University, the exhibition navigates the Weekend's theme of **Built/Unbuilt** through a series of thoughtful encounters in which artists reveal the invisible stories and issues in corners of the city.

**Take Hold of the Clouds** brings together cross-disciplinary creative practitioners from the visual arts, architecture, design, sound and film to make an installation or creative work in response to selected sites, ranging from buildings to urban landscapes to community spaces.

The exhibition features two key existing works by international contributors—**Forensic Architecture's Cloud Studies** (2021) and **Cauleen Smith's Sojourner** (2018)—along with six, newly commissioned, responsive works from local and national creative practitioners.

The experimental project is distributed across seven of the city's most loved and significant spaces, with each temporal creative work adding a new layer to how we understand these spaces in relation to the world around us.

Embedding the work within the city itself rather than a traditional gallery, the exhibition models best practices for high-impact yet sustainable and resource-sensitive exhibition-making.

The exhibition is conceived by Tara McDowell, Director of Curatorial Practice at Monash Art, Design and Architecture, and co-curated with Fleur Watson, Open House Melbourne's Executive Director.



## WORKS AND SITES



**CAULEEN SMITH**  
*Sojourner*  
Victorian Quaker Centre  
Installed in the Worship Space of the Victorian Quaker Centre, artist and filmmaker Cauleen Smith's 2018 video *Sojourner* imagines the possibilities of a deeply generous, feminist, and Afrofuturist community through a pilgrimage to sites of utopian community-building in America. There have been moments in human history when we have aspired to, and even achieved, acts of radical generosity towards each other—this is the history Smith sets out to document in *Sojourner*.

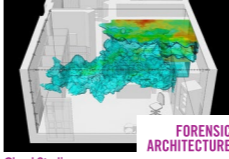

**CLOUD STUDIES**  
The Capitol, RMIT University  
**Forensic Architecture's Cloud Studies** (2021) is an investigation into toxic air, and the way in which the atmosphere—including the air we breathe—can be weaponised, and transformed into acts of state violence, colonialism, capitalism and racism. Throughout Open House Melbourne's July Weekend 2022, *Cloud Studies* will run on a loop in The Capitol's main cinema, the crystalline ceiling providing a powerful counterpoint to the devastating narrative on screen. Archival films supplementing the screening will be viewable in the lobby.



**YING-LAN DANN**  
*Circular Temporalities*  
Mission to Seafarers  
Inside the iconic Norla Dome at Mission to Seafarers, Ying-Lan Dann's newly commissioned installation, *Circular Temporalities* (2022), brings together audio and video field recordings that consider the site's relationship to global seafaring—and to the mariners stranded at sea during the pandemic. The primary component of the work is a large-scale video projection of the sea crossing between Queenscliff and Sorrento shot from the ferry.



**ALICIA FRANKOVICH**  
*The Eye*  
Brunswick Baths  
**One-night-only performance**  
Saturday 30th July at 7pm  
Bookings required via the website  
At the Brunswick Baths, Alicia Frankovich presents *The Eye* (2022), a live performance sited at the main indoor pool. The indoor heated pool becomes like a stage or gallery space around which the audience gathers in expectation of the experience about to unfold. Frankovich uses the pool environment for this new performance, recognising climate change and ignoring rising sea levels as a condition of contemporary life.



**JULIA MCINERNEY**  
Joanna  
Villa Alba Museum  
Julia McInerney's new installation *Joanna* (2022) includes photography, sculpture, and film, and unfolds in several rooms of the Villa Alba Museum. The work is titled for the artist's mother, Joanna. The camellia recurs throughout the installation referencing the memory that the artist holds of her mother as well as McInerney's ongoing investigation into Ina Higgins, Melbourne's first female landscape architect.

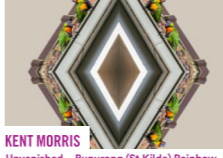

**KENT MORRIS**  
*Unvanishes—Bunurong (St Kilda) Rainbow Lorikeet #2*  
St Kilda Foreshore Vaults  
Kent Morris, a Barkindji man living on the lands of the Bunurong people in Naarm Melbourne, has selected the St Kilda Foreshore Vaults as the site of a major new public artwork in his ongoing *Unvanishes* series. *Unvanishes—Bunurong (St Kilda) Rainbow Lorikeet #2* (2022) is an expansive four-panel photographic installation of local rainbow lorikeets transforming from black-and-white to full colour.

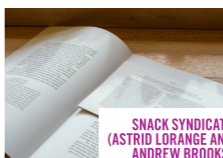

**SNACK SYNDICATE (ASTRID LORANGE AND ANDREW BROOKS)**  
*These Thoughts Large and Public*  
Victorian Trades Hall & Literary Institute  
Snack Syndicate will inhabit the Victorian Trades Hall to revive the historic 3KZ radio station for *These Thoughts Large and Public* (2022), a series of readings, talks and conversations around the history and future of labour, accompanied by tea and pastries. The program is open to the public and broadcast live over the Saturday and Sunday of the Open House Melbourne July Weekend and will take place in Solidarity Hall.

Photography courtesy (Left column, top to bottom): [1] Still from *Sojourner*, 2018. Image: Cauleen Smith. [2] From *The Murder of Healy Yorgat*, 2017. [Cloud Studies, 2021] © Forensic Architecture. [3] Ying-Lan Dann at Mission to Seafarers. Image: Tara McDowell. [4] Alicia Frankovich, *AG20200* (2020) Auckland Art Gallery Toi o Tamaki. Image: Alicia Frankovich. [Right column, top to bottom]: [5] *Wiliin Garden* Photograph, 2020. Image: Julia McInerney. [6] *Unvanishes—Bunurong (St Kilda) Rainbow Lorikeet #2*, 2022. Image: Kent Morris and Vivian Anderson Gallery. [7] *Endless Study*, Infinite Data: Occasional GPS, exhibited/performed at Shaper/Flare: New Forms of Curatorial Research, MAQA Gallery, Caulfield East, March 2019. Image: Keelan O'Hair.

SPONSORS & PATRONS 2022

MAJOR PARTNERS

PRECINCT PARTNERS

MAJOR PRECINCT PARTNERS

PRACTICE PARTNERS

PROGRAM PARTNERS

ARCHITECTURE

ARCHITECT TEAM

MEIA AND DIGITAL PARTNERS

# BUILT/UNBUILT

## OPEN HOUSE MELBOURNE

### 2022 PROGRAM 30+31 JULY 2022

Various opening times across 30+31 July 2022. For further details see the QR code or visit [takeholdoftheclouds.com](http://takeholdoftheclouds.com)

Various opening times across 30+31 July 2022. For further details see the QR code or visit [takeholdoftheclouds.com](http://takeholdoftheclouds.com)



# WESTERN TREATMENT PLANT TOURS 11+20 SEPTEMBER

# 150

IN-PERSON ATTENDANCE

# 97

ONLINE

We partnered with Melbourne Water (MW) to deliver special in-person tours of the Western Treatment Plant (WTP), a world leader in environmentally friendly sewage treatment, not normally open to the public. MW's innovations in sewerage systems recover and transform our waste, turning it into water, nutrients and energy ready for re-use. Not only a site of historical, cultural and environmental significance, WTP doubles as a working farm and is internationally recognised for its rich biodiversity, providing a home to native birds and plants. It's this crossover between the treatment plant's constructed facilities and the site's rich biodiversity that promotes Melbourne's renowned liveability. One-hour and two-hour extended tours were offered and sold out quickly demonstrating an interest within our audience in the infrastructure and systems that support our city. The guided virtual tour, led by MW education and heritage staff, offered an opportunity for a wider audience to access the program and the engagement and feedback was overwhelmingly positive.



# OPEN HOUSE BENDIGO 22+23 OCTOBER

# 3,538

IN-PERSON ATTENDANCE

The Open House team was delighted to return to Bendigo for the Open House Bendigo Weekend 2022 program and 'open up' more than 20 buildings, spaces, talks and programs across the city for everyone to enjoy.

The festival shone a light on spaces of architectural excellence, be it significant heritage sites or contemporary design. The program aspired to create a sense of civic pride in the changing urban environment of Greater Bendigo—with access to multiple historic sites and a diverse range of modern buildings, catering for heritage and contemporary design lovers alike.

This year, Open House worked collaboratively with local partners to curate the program including the Dja Dja Wurrung Clans Aboriginal Corporation, the Greater City of Bendigo and the La Trobe Institute of Arts—the latter of which was an Open House Bendigo (OHB) 'hub' for programs including our mini-marathon talk series titled Culture of Place: Bendigo and the Big Build, which explored the contribution and impact of three new, large-scale civic and educational buildings that are shaping the centre of the city.

Culture of Place opened with an address from Jill Garner, Office of the Victorian Government Architect (OVGA), who set the scene for the Big Build projects, followed by a generous presentation exploring 'designing with culture & country' by Dja Dja Wurrung artist Rebecca Phillips in collaboration with Anne-Marie Pisani from Aspect Studios. These two positional presentations were closely followed by short, illustrated talks that provided a deep dive into the design process of the three Big Build projects—Galkangu GovHub presented by Adam Pustola from Lyons; Bendigo Law Courts by Meaghan Dwyer and Kah-Fai Lee from John Wardle architects (JWA) and the Bendigo TAFE presented by Jayden Peacock from Architectus.

Additional Saturday program highlights included an opening Walk on Country and Smoking led by Dja Dja Wurrung Traditional Owners exploring the landscape, frog ponds and future to re-imagine and renew the Bendigo Creek; a landscape tour of Bendigo's Garden for the Future led by TCL landscape architects; the regional premiere of *Modern Melbourne* featuring the work of architect Peter Elliott screened at the historic Star Cinema and The Big Draw—an interactive workshop at Bendigo Gallery for children and families. Sunday saw guided tours of the Returned Soldiers' Memorial Hall led by Lovell Chen; plus, tours of the Former Bendigo Mining Exchange's restoration within the Beehive Building, guided by Williams Boag Architects.

The Weekend culminated with architect and housing advocate Tania Davidge hosting an insightful and vital discussion at Bendigo's Engine Room that focused on issues that influence the provision of social and affordable housing in the region.





# VOLUNTEER ENGAGEMENT



Open House Melbourne programs would not be possible without the extraordinary commitment and generous support of our volunteers.

**553**

**VOLUNTEERS RECRUITED AND SHIFTS COMPLETED**

**2400+**

**VOLUNTEER HOURS CONTRIBUTED**

**18–82**

**AGE RANGE OF OPEN HOUSE VOLUNTEERS**

**90%**

**VOLUNTEER TO GIVE BACK TO AN EVENT THEY ENJOY AS A PATRON**

**97%**

**VOLUNTEER TO CELEBRATE MELBOURNE AND ENGAGE WITH THE LOCAL COMMUNITY**

**56%**

**PARTICIPATED FOR THE FIRST TIME IN 2022**

**125**

**VOLUNTEERED FOR FIVE OR MORE YEARS**

**25**

**HAVE VOLUNTEERED FOR TEN OR MORE YEARS**

# REACH + PROFILE

## • ATTENDANCE

**86,595**

TOTAL

**73,648**

IN-PERSON VISITATION

**12,947**

ONLINE

## • WEBSITE

In comparison to 2021, there has been an increase of 67.36% across unique visitors accessing the website with a 69.34% increase in new users. Sessions are up by 70.94%, number of sessions grew by 2.11%, pages per session increased by 26.49% and average session duration climbed by 13.98%. We also found a -70.86% decrease in the bounce rate in 2022, indicating that audiences have grown to include new users who engaged with the website for longer periods of time.

Just over 50% of users are accessing the website from a mobile device, with around 45% accessing from desktop and the remaining from tablets. This is a positive indication that the responsive design of the Open House Melbourne website—from both UX and graphic design approaches—is functioning well across all platforms. Users peaked on 30 June (7,111) for the July program launch and 31 July (7,040) for the program itself.

This year we integrated the Userway platform into our website, which adds an accessibility menu to enhance usability and UI/UX in line with our strategic pillar of Equality, Accessibility and Dignity.

Most of the website traffic came via direct traffic (38.7%) and organic search (38.6%), demonstrating the strength of OHM's brand awareness amongst our audience. This, combined with the high level of new users also suggests that brand awareness is expanding to a wider audience.

**146,363**

UNIQUE VISITORS  
ACCESS TO  
WEBSITE (INCREASE  
OF 67.36%)

**648,989**

WEBSITE UNIQUE  
PAGE VIEWS  
(INCLUDING  
THOTC: 8,333)

**69.34%**

GROWTH OF NEW  
USERS

**-70.86%**

DECREASE OF  
BOUNCE RATE

**110.35%**

GROWTH OF UNIQUE  
PAGE VIEWS

## • NEWSLETTER

Our newsletter continues to be one of our strongest channels for promoting our programs and on-demand content. Our highest performing EDMs this year include the July program live newsletter with a 7.9% click rate and the July program highlights newsletter with a 6.4% click rate, suggesting that our audience is most engaged with our content during the OHM July Weekend campaign.

**46,770**

EDM SUBSCRIBERS (5.3% INCREASE)

**45.8%**

OPEN RATE (11.3% INCREASE)

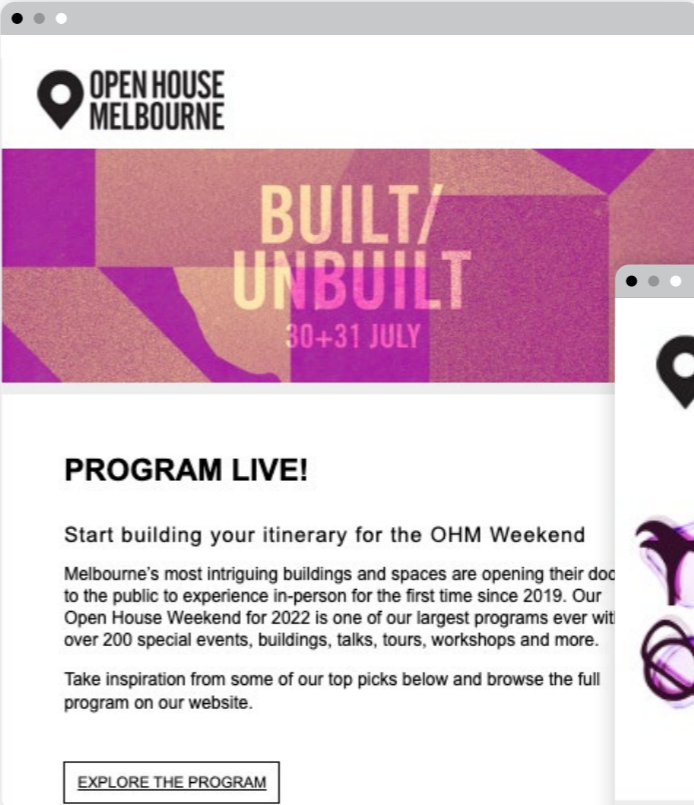

## • SOCIAL MEDIA

Open House's organic social media activity continues to foster engagement and advocacy within our community, promote and support our partners, stakeholders and collaborators and encourage attendance at Open House programs. We engage an active audience of 58,600+ across all platforms including Facebook (27,100+ followers), Instagram (19,400+ followers), Twitter (9,600+ followers), LinkedIn (1500+ followers) and YouTube (830+ subscribers). These platforms have seen sustained growth resulting in a 4% increase in followers from 2021.

**105,390**

TOTAL DATABASE—EDM SUBSCRIBERS  
AND SOCIAL MEDIA (INCREASE OF 4%  
ON 2021)

**58,622**

SOCIAL MEDIA FOLLOWERS



## • MEDIA EVALUATION

Our media campaign led by partners Zilla & Brook generated high visibility for our programs, with 181 media hits and a total of \$8,150,961 in PR value across our three major campaigns this year: Open Nature, OHM July Weekend and Open House Bendigo.

# 7,874,874

TOTAL MEDIA REACH ACROSS PRINT,  
ONLINE, TV AND RADIO

## • PROFILE RAISING

Increasing the profile of the OHM leadership team is critical in realising our ambition as a leading public-facing organisation. Below is a selection of interviews and media opportunities undertaken by Fleur Watson and/or Stuart Harrison on behalf of the organisation throughout 2022.

### OPEN NATURE

- Interview with Fleur Watson on ABC Radio Melbourne, Saturday Breakfast with Alice Zaslavsky
- Interview with Fleur Watson on ABC Radio Melbourne, Evenings with David Astle
- Interview with Fleur Watson on ABC Radio Gippsland, Breakfast with Mim Cook

### OPEN HOUSE MELBOURNE JULY WEEKEND

- OHM July 2022 Program Launch at Melbourne Connect
- Interview with Fleur Watson for The Urban Developer with Ralph Nicholson
- Interview with Fleur Watson for Behind the Scenes, Vision Australia Radio
- Interview with Fleur Watson for ABC News with Annie Kearney

### OPEN HOUSE BENDIGO

- Interview with Fleur Watson on ABC Radio Melbourne with Raf Epstein
- Interview with Stuart Harrison on ABC Radio Melbourne with Andrew Hansen
- Interview with Fleur Watson & Stuart Harrison on On Nights on 3AW with Denis Walter
- Interview with Fleur Watson on The Wake Up Call with Mark Robinson & Steve Kendall





# LEARNINGS + REFLECTIONS

In the aftermath of two years of isolation and lockdowns due to the COVID-19 pandemic, it was clear that Victorians were ready and, in fact, highly anticipated a return to live talks, tours, events and programs. OHM's much-valued funding partners, practice and precinct partners, sponsors and collaborators also clearly expressed a commitment to 'in-person' programming with a limited appetite for online or virtual programming. It is within this context, that our flagship program—the OHM July Weekend 2022 program—offered over 200+ predominantly physical programs including talks, tours, exhibitions, events and exhibitions across the course of the festival program.

While it was deeply rewarding to physically encounter and re-establish our collective relationship with our city and suburbs' buildings and spaces and to discuss and debate the pressing issues and challenges that are shaping our built environment with live audiences in our theatres and public spaces, we must also remain mindful of the lessons learnt throughout the past three years as we continue to emerge from the experience of the pandemic.

Hybrid programming—where physical and digital options are concurrently available via live-streaming with online AUSLAN interpretation—continues to offer increased inclusivity for those who may be unable to access physical programming due to a multitude of factors. Virtual and online programming also allows for greater access to specific parts of our program such as walks, tours and talks with limitations due to accessibility, security, or public safety. It also opens the program up to audiences who otherwise are not able to engage with the event due to distance or other factors.

This year we produced a collaborative exhibition project *Take Hold of the Clouds* with Tara McDowell, Director of Curatorial Practice at Monash University's Faculty of Art, Design and Architecture. As part of the project, we were fortunate to work with (and to learn from) Fayen d'Evie—an artist, writer and practice-based creative researcher whose work directly engages with issues of access and inclusion. Fayen led a research-led process with designers Luke Rigby and Yue Yang in collaboration with students from d'Evie's Experimental Typography course at RMIT University.

Titled *Open House/Open Access*, d'Evie's approach lay in stark contrast to a typical top-down or institutional approach to access and inclusion. Instead, the collaborative methodology explored diverse strategies to increase accessibility including alt-text, responsive typographical treatments and a purpose-designed website and publication (print and online) containing QR codes with audio-recorded responsive texts as an alternative mode of wayfinding for the exhibition and providing access to the ideas in each work long beyond its ephemeral physical duration.

*Take Hold of the Clouds* marked the first in what we hope will be an ongoing series of new partnered curated projects that set up the conditions for critical interventions into Open House Melbourne's large-scale, annual festival-like program. Exploratory and research-led partnered projects such as this are vital to Open House Melbourne's commitment to instigating cross-disciplinary exchange across expanded spatial practice; increased accessibility and inclusion across our programs that shape our remit to empower all citizens to be active participants in the shaping of better futures for their cities, suburbs and regions. These learnings continue to underpin our approach to the future and inform our ambitions for OHM programming.

Central to our aspirations is a shared vision for OHM's future and a clear 'road map' for the organisation's strategic objectives. This year, the OHM Board, executive and team worked closely with Greenshoot Consulting over several facilitated workshops to evolve and refine the organisation's strategic plan. Here, we defined our vision and mission and defined six strategic objectives or 'pillars' that will guide the organisation and our programming ambitions over the next three years. Thank you to Studio Payne for so clearly articulating our guiding principles in the graphic design of OHM's new 'strategic compass' (see pp.4–5)—a visualisation of our strategic objectives over the next three years.

## FLEUR WATSON

Executive Director | Chief Curator, Open House Melbourne



# APPENDIX

- **OPEN NATURE 2022  
PROGRAM REPORT**

↘ [DOWNLOAD HERE](#)

- **OPEN HOUSE MELBOURNE 2022  
PROGRAM REPORT**

↘ [DOWNLOAD HERE](#)

- **OPEN HOUSE MELBOURNE 2022  
FINANCIAL REPORT**

↘ [DOWNLOAD HERE](#)



